

区画16号線 1

区画16号線

区画14号線

区画12号線

8号水路の内

区画7号線

矢野野路線-1

区画9号線

8号水路の内

4号公園

1号公園

区画3号線

区画8号線

区画3号線-1

区画4号線

29

30

31

32

33

37

野路平野線 (1)

区画1号線

区画6号線

区画1号線

野路平野線 (1)-1

区画2号線

野路平野線 (2)

50

野路線-1

野路線

区画10号線

2号公園

1号水路

区画5号線

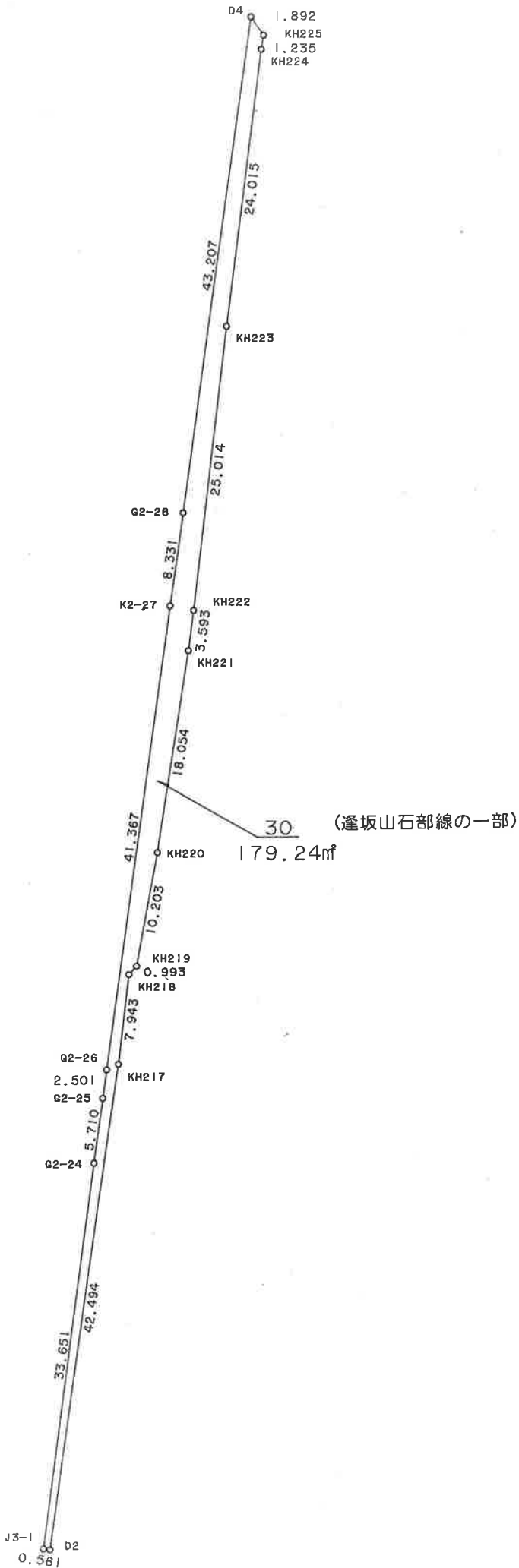

* * 面積計算 (倍横距法) * *

地 器械点	番 : 30 視準点	内角	方向角	距離	緯距	經距	X座標	Y座標	倍横距	倍面積
D4	G2-28	41-36-01	217-39-41	43.207	-34.204	-26.399	-110927.154	-4198.600	-26.399	902.951396
G2-28	K2-27	179-59-58	217-39-39	8.331	-6.595	-5.090	-110933.749	-4203.690	-57.888	381.771360
K2-27	G2-26	179-59-57	217-39-36	41.367	-32.748	-25.274	-110966.497	-4228.964	-88.252	2890.076496
G2-26	G2-25	180-02-54	217-42-30	2.501	-1.979	-1.530	-110968.476	-4230.494	-115.056	227.695824
G2-25	G2-24	180-12-48	217-55-18	5.710	-4.504	-3.509	-110972.980	-4234.003	-120.095	540.907880
G2-24	J3-1	179-45-58	217-41-16	33.651	-26.630	-20.573	-110999.610	-4254.576	-144.177	3839.433510
J3-1	D2	90-30-35	128-11-51	0.561	-0.347	0.441	-110999.957	-4254.135	-164.309	57.015223
D2	KH217	90-00-49	38-12-40	42.494	33.389	26.285	-110966.568	-4227.850	-137.583	-4593.758787
KH217	KH218	178-28-53	36-41-33	7.943	6.369	4.746	-110960.199	-4223.104	-106.552	-678.629688
KH218	KH219	214-27-11	71-08-44	0.993	0.321	0.940	-110959.878	-4222.164	-100.866	-32.377986
KH219	KH220	149-07-54	40-16-38	10.203	7.784	6.596	-110952.094	-4215.568	-93.330	-726.480720
KH220	KH221	178-14-06	38-30-44	18.054	14.127	11.242	-110937.967	-4204.326	-75.492	-1066.475484
KH221	KH222	178-44-25	37-15-09	3.593	2.860	2.175	-110935.107	-4202.151	-62.075	-177.534500
KH222	KH223	179-17-23	36-32-32	25.014	20.097	14.894	-110915.010	-4187.257	-45.006	-904.485582
KH223	KH224	180-21-30	36-54-02	24.015	19.204	14.419	-110895.806	-4172.838	-15.693	-301.368372
KH224	KH225	181-29-28	38-23-30	1.235	0.968	0.767	-110894.838	-4172.071	-0.507	-0.490776
KH225	D4	137-40-10	356-03-40	1.892	1.888	-0.130	-110892.950	-4172.201	0.130	0.245440
									倍面積	358.495234
									面積	179.2476170
									坪数	54.22

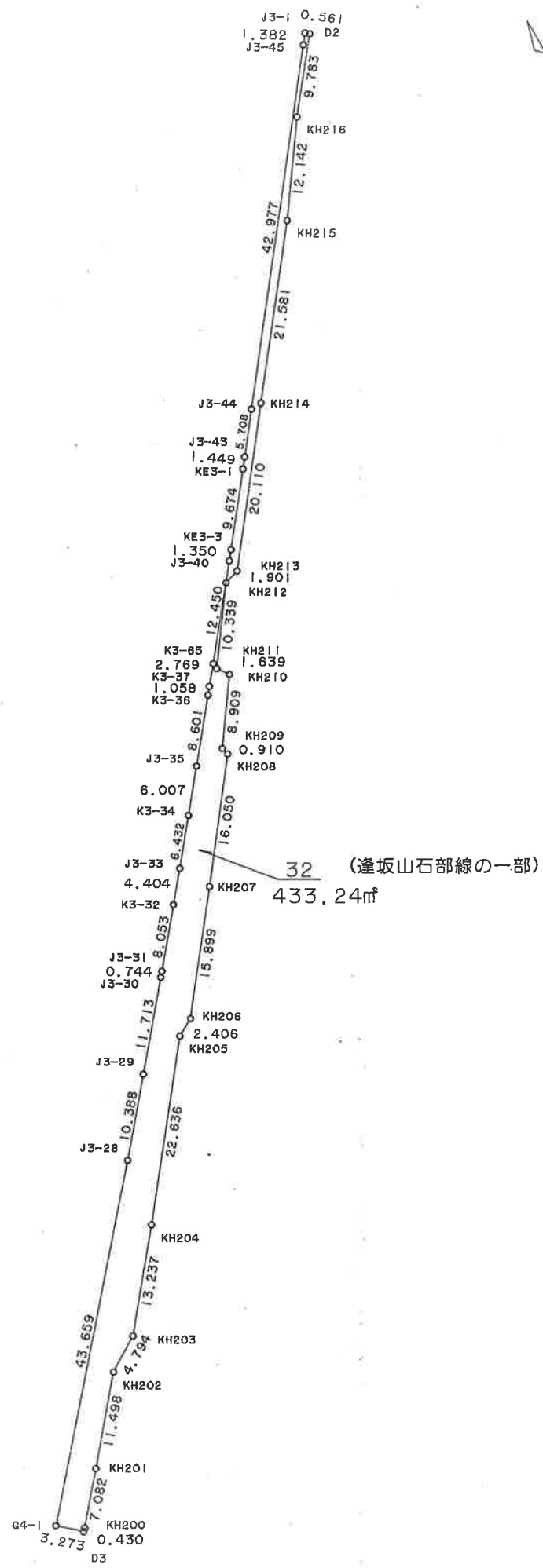

* * 面積計算 (倍横距法) * *

地 器械点	番 : 32 視準点	内角	方向角	距離	緯距	經距	X座標	Y座標	倍横距	倍面積
J3-1	J3-45	89-32-35	217-44-26	1.382	-1.093	-0.846	-111000.703	-4255.422	-0.846	0.924678
J3-45	J3-44	179-56-42	217-41-08	42.977	-34.011	-26.273	-111034.714	-4281.695	-27.965	951.117615
J3-44	J3-43	180-05-02	217-46-10	5.708	-4.512	-3.496	-111039.226	-4285.191	-57.734	260.495808
J3-43	KE3-1	180-10-05	217-56-15	1.449	-1.143	-0.891	-111040.369	-4286.082	-62.121	71.004303
KE3-1	KE3-3	179-59-46	217-56-01	9.674	-7.630	-5.947	-111047.999	-4292.029	-68.959	526.157170
KE3-3	J3-40	179-59-50	217-55-51	1.350	-1.065	-0.830	-111049.064	-4292.859	-75.736	80.658840
J3-40	K3-65	180-30-51	218-26-42	12.450	-9.751	-7.741	-111058.815	-4300.600	-84.307	822.077557
K3-65	K3-37	180-43-20	219-10-02	2.769	-2.147	-1.749	-111060.962	-4302.349	-93.797	201.382159
K3-37	K3-36	179-30-04	218-40-06	1.058	-0.826	-0.661	-111061.788	-4303.010	-96.207	79.466982
K3-36	J3-35	180-03-33	218-43-39	8.601	-6.710	-5.381	-111068.498	-4308.391	-102.249	686.090790
J3-35	K3-34	180-20-26	219-04-05	6.007	-4.664	-3.786	-111073.162	-4312.177	-111.416	519.644224
K3-34	J3-33	180-00-48	219-04-53	6.432	-4.993	-4.055	-111078.155	-4316.232	-119.257	595.450201
J3-33	K3-32	180-25-04	219-29-57	4.404	-3.398	-2.801	-111081.553	-4319.033	-126.113	428.531974
K3-32	J3-31	180-07-30	219-37-27	8.053	-6.203	-5.136	-111087.756	-4324.169	-134.050	831.512150
J3-31	J3-30	180-04-58	219-42-25	0.744	-0.572	-0.475	-111088.328	-4324.644	-139.661	79.886092
J3-30	J3-29	180-12-18	219-54-43	11.713	-8.984	-7.515	-111097.312	-4332.159	-147.651	1326.496584
J3-29	J3-28	180-02-06	219-56-49	10.388	-7.964	-6.670	-111105.276	-4338.829	-161.836	1288.861904
J3-28	G4-1	181-00-54	220-57-43	43.659	-32.969	-28.621	-111138.245	-4367.450	-197.127	6499.080063
G4-1	D3	91-20-20	132-18-03	3.273	-2.203	2.421	-111140.448	-4365.029	-223.327	491.989381
D3	KH200	90-03-45	42-21-48	0.430	0.318	0.290	-111140.130	-4364.739	-220.616	-70.155888
KH200	KH201	178-16-23	40-38-11	7.082	5.374	4.612	-111134.756	-4360.127	-215.714	-1159.247036
KH201	KH202	179-37-59	40-16-10	11.498	8.773	7.432	-111125.983	-4352.695	-203.670	-1786.796910
KH202	KH203	197-49-26	58-05-36	4.794	2.534	4.070	-111123.449	-4348.625	-192.168	-486.953712
KH203	KH204	161-12-05	39-17-41	13.237	10.244	8.383	-111113.205	-4340.242	-179.715	-1841.000460
KH204	KH205	179-06-02	38-23-43	22.636	17.741	14.059	-111095.464	-4326.183	-157.273	-2790.180293
KH205	KH206	203-09-55	61-33-38	2.406	1.146	2.116	-111094.318	-4324.067	-141.098	-161.698308
KH206	KH207	156-24-23	37-58-01	15.899	12.534	9.781	-111081.784	-4314.286	-129.201	-1619.405334

器械点	視準点	内角	方向角	距離	緯距	經距	X座標	Y座標	倍橫距	倍面積
KH207	KH208	179-28-06	37-26-07	16.050	12.744	9.756	-111069.040	-4304.530	-109.664	-1397.558016
KH208	KH209	128-38-07	346-04-14	0.910	0.883	-0.219	-111068.157	-4304.749	-100.127	-88.412141
KH209	KH210	229-11-15	35-15-29	8.909	7.275	5.143	-111060.882	-4299.606	-95.203	-692.601825
KH210	KH211	110-15-25	325-30-54	1.639	1.351	-0.928	-111059.531	-4300.534	-90.988	-122.924788
KH211	KH212	250-21-18	35-52-12	10.339	8.378	6.058	-111051.153	-4294.476	-85.858	-719.318324
KH212	KH213	215-53-09	71-45-21	1.901	0.595	1.805	-111050.558	-4292.671	-77.995	-46.407025
KH213	KH214	145-56-01	37-41-22	20.110	15.914	12.295	-111034.644	-4280.376	-63.895	-1016.825030
KH214	KH215	180-06-25	37-47-47	21.581	17.053	13.226	-111017.591	-4267.150	-38.374	-654.391822
KH215	KH216	177-12-00	34-59-47	12.142	9.947	6.964	-111007.644	-4260.186	-18.184	-180.876248
KH216	D2	183-12-45	38-12-32	9.783	7.687	6.051	-110999.957	-4254.135	-5.169	-39.734103
D2	J3-1	89-59-19	308-11-51	0.561	0.347	-0.441	-110999.610	-4254.576	0.441	0.153027
									倍面積	866.494239
									面積	433.2471195
									坪数	131.05

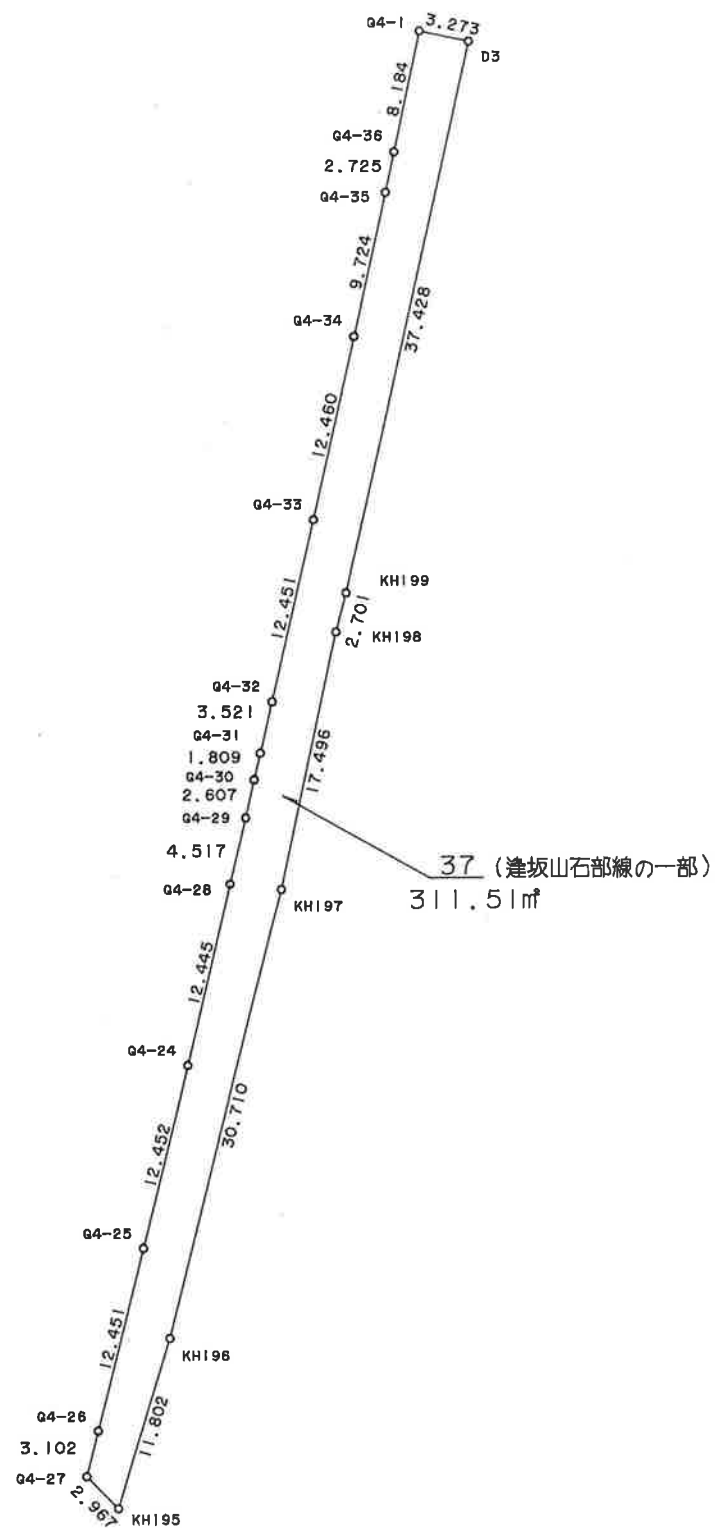
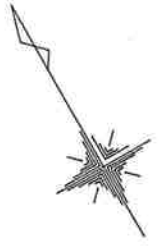

* * 面積計算 (倍横距法) * *

地 器械点	番 : 37 視準点	内角	方向角	距離	緯距	經距	X座標	Y座標	倍横距	倍面積
G4-1	G4-36	89-23-08	221-41-11	8.184	-6.112	-5.443	-111144.357	-4372.893	-5.443	33.267616
G4-36	G4-35	180-02-29	221-43-40	2.725	-2.034	-1.814	-111146.391	-4374.707	-12.700	25.831800
G4-35	G4-34	180-17-31	222-01-11	9.724	-7.224	-6.509	-111153.615	-4381.216	-21.023	151.870152
G4-34	G4-33	180-18-00	222-19-11	12.460	-9.213	-8.389	-111162.828	-4389.605	-35.921	330.940173
G4-33	G4-32	180-25-53	222-45-04	12.451	-9.143	-8.452	-111171.971	-4398.057	-52.762	482.402966
G4-32	G4-31	180-06-30	222-51-34	3.521	-2.581	-2.395	-111174.552	-4400.452	-63.609	164.174829
G4-31	G4-30	180-06-08	222-57-42	1.809	-1.324	-1.233	-111175.876	-4401.685	-67.237	89.021788
G4-30	G4-29	179-46-08	222-43-50	2.607	-1.915	-1.769	-111177.791	-4403.454	-70.239	134.507685
G4-29	G4-28	180-41-27	223-25-17	4.517	-3.281	-3.105	-111181.072	-4406.559	-75.113	246.445753
G4-28	G4-24	179-57-38	223-22-55	12.445	-9.045	-8.548	-111190.117	-4415.107	-86.766	784.798470
G4-24	G4-25	180-27-11	223-50-06	12.452	-8.982	-8.624	-111199.099	-4423.731	-103.938	933.571116
G4-25	G4-26	180-14-04	224-04-10	12.451	-8.946	-8.660	-111208.045	-4432.391	-121.222	1084.452012
G4-26	G4-27	180-11-57	224-16-07	3.102	-2.221	-2.165	-111210.266	-4434.556	-132.047	293.276387
G4-27	KH195	121-43-41	165-59-48	2.967	-2.879	0.718	-111213.145	-4433.838	-133.494	384.329226
KH195	KH196	60-55-46	46-55-34	11.802	8.060	8.621	-111205.085	-4425.217	-124.155	-1000.689300
KH196	KH197	177-17-06	44-12-40	30.710	22.012	21.414	-111183.073	-4403.803	-94.120	-2071.769440
KH197	KH198	177-44-08	41-56-48	17.496	13.013	11.695	-111170.060	-4392.108	-61.011	-793.936143
KH198	KH199	182-26-18	44-23-06	2.701	1.930	1.889	-111168.130	-4390.219	-47.427	-91.534110
KH199	D3	177-54-59	42-18-05	37.428	27.682	25.190	-111140.448	-4365.029	-20.348	-563.273336
D3	G4-1	89-59-58	312-18-03	3.273	2.203	-2.421	-111138.245	-4367.450	2.421	5.333463
									倍面積	623.021107
									面積	311.5105535
									坪数	94.23

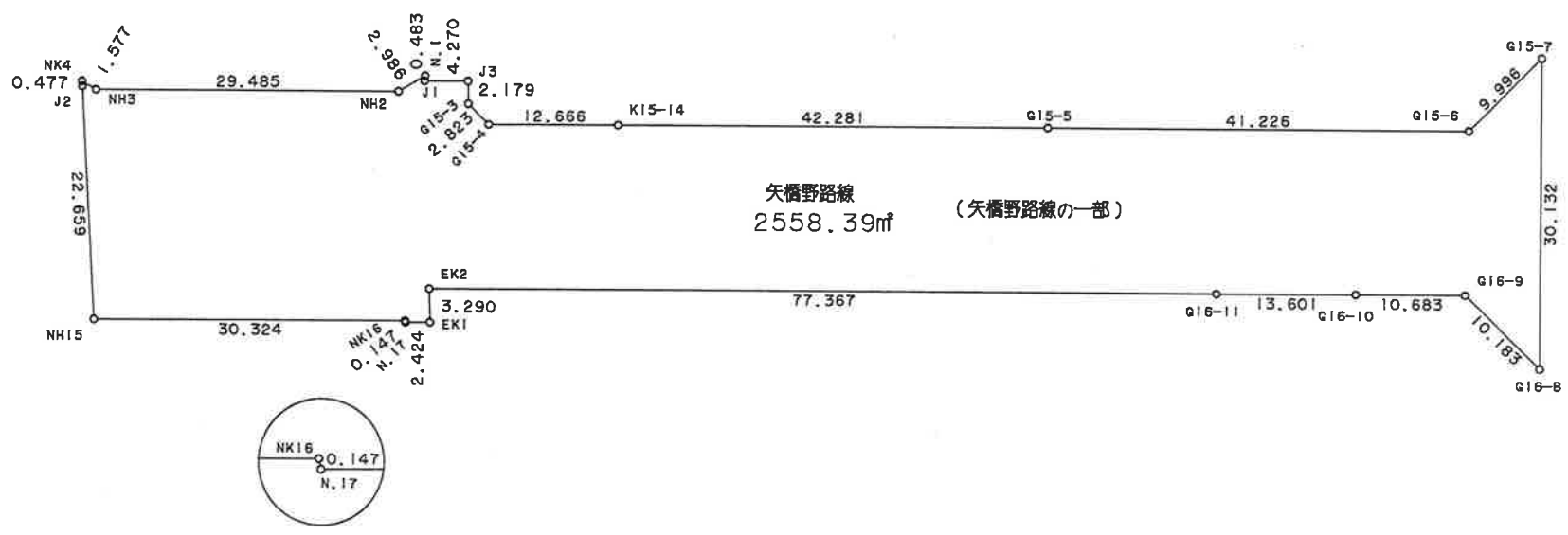
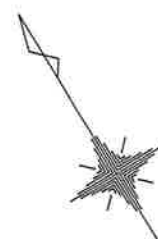

* * 面積計算 (倍横距法) * *

地 器械点	番 : 矢橋野路線 視準点	内角	方向角	距離	緯距	經距	X座標	Y座標	倍横距	倍面積
G15-7	G15-6	44-58-50	257-00-33	9.996	-2.247	-9.740	-110872.477	-4414.797	-9.740	21.885780
G15-6	G15-5	224-59-49	302-00-22	41.226	21.850	-34.959	-110850.627	-4449.756	-54.439	-1189.492150
G15-5	K15-14	180-00-20	302-00-42	42.281	22.413	-35.852	-110828.214	-4485.608	-125.250	-2807.228250
K15-14	G15-4	179-59-58	302-00-40	12.666	6.714	-10.740	-110821.500	-4496.348	-171.842	-1153.747188
G15-4	G15-3	224-53-00	346-53-40	2.823	2.749	-0.640	-110818.751	-4496.988	-183.222	-503.677278
G15-3	J3	224-14-59	31-08-39	2.179	1.865	1.127	-110816.886	-4495.861	-182.735	-340.800775
J3	J1	90-33-30	301-42-09	4.270	2.244	-3.633	-110814.642	-4499.494	-185.241	-415.680804
J1	N.1	275-54-08	37-36-17	0.483	0.383	0.295	-110814.259	-4499.199	-188.579	-72.225757
N.1	NH2	54-29-14	272-05-31	2.986	0.109	-2.984	-110814.150	-4502.183	-191.268	-20.848212
NH2	NH3	209-58-48	302-04-19	29.485	15.656	-24.985	-110798.494	-4527.168	-219.237	-3432.374472
NH3	NK4	209-52-06	331-56-25	1.577	1.392	-0.742	-110797.102	-4527.910	-244.964	-340.989888
NK4	J2	56-46-33	208-42-58	0.477	-0.418	-0.229	-110797.520	-4528.139	-245.935	102.800830
J2	NH15	180-07-37	208-50-35	22.659	-19.848	-10.931	-110817.368	-4539.070	-257.095	5102.821560
NH15	NK16	93-11-23	122-01-58	30.324	-16.084	25.707	-110833.452	-4513.363	-242.319	3897.458796
NK16	N.17	258-45-07	200-47-05	0.147	-0.137	-0.052	-110833.589	-4513.415	-216.664	29.682968
N.17	EK1	100-55-30	121-42-35	2.424	-1.274	2.062	-110834.863	-4511.353	-214.654	273.469196
EK1	EK2	88-35-49	30-18-24	3.290	2.840	1.660	-110832.023	-4509.693	-210.932	-599.046880
EK2	G16-11	271-43-06	122-01-30	77.367	-41.027	65.593	-110873.050	-4444.100	-143.679	5894.718333
G16-11	G16-10	179-55-01	121-56-31	13.601	-7.196	11.542	-110880.246	-4432.558	-66.544	478.850624
G16-10	G16-9	179-57-46	121-54-17	10.683	-5.646	9.069	-110885.892	-4423.489	-45.933	259.337718
G16-9	G16-8	224-09-41	166-03-58	10.183	-9.883	2.452	-110895.775	-4421.037	-34.412	340.093796
G16-8	G15-7	45-57-45	32-01-43	30.132	25.545	15.980	-110870.230	-4405.057	-15.980	-408.209100
									倍面積	5116.798847
									面積	2558.3994235
									坪数	773.91

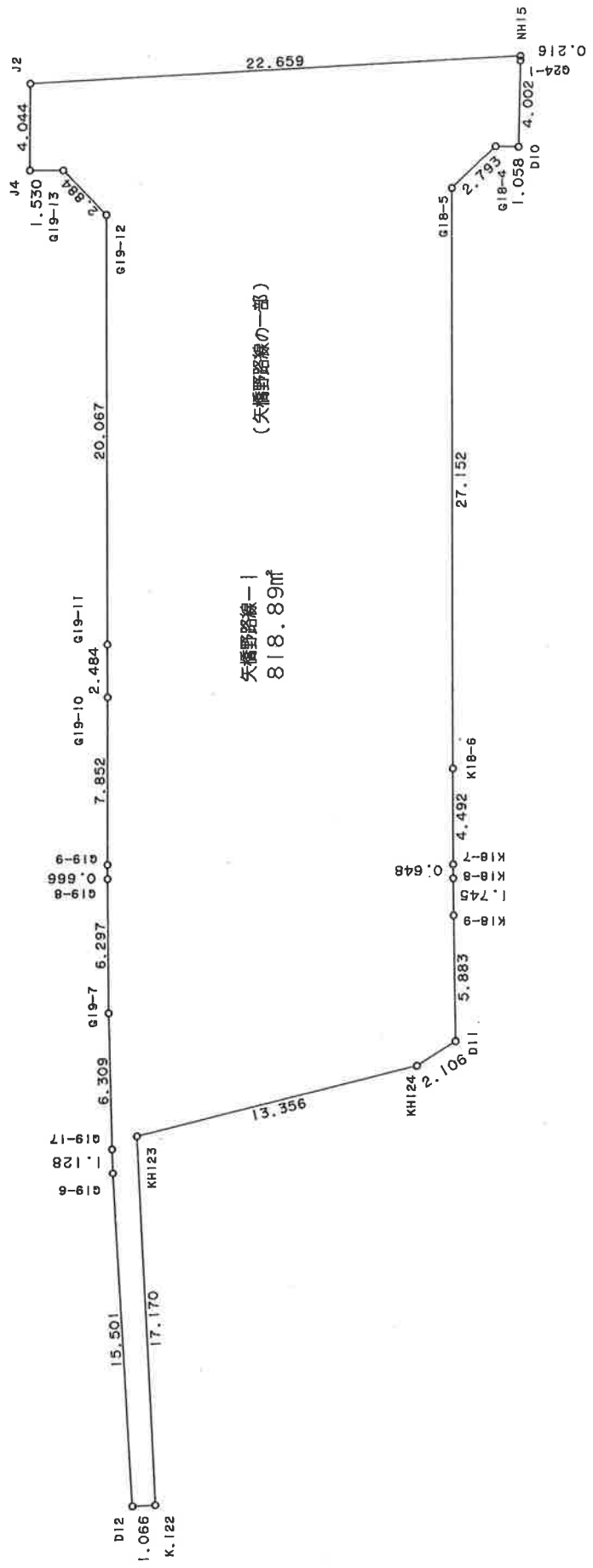
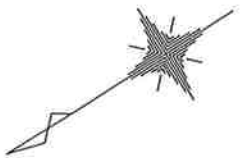

* * 面積計算 (倍横距法) * *

地 器 械 点	番 視 準 点	矢橋野路線-1 内角	方向角	距離	緯距	經距	X座標	Y座標	倍横距	倍面積
D12	K.122	90-00-11	208-49-30	1.066	-0.934	-0.514	-110767.139	-4587.369	-0.514	0.480076
K.122	KH123	90-31-17	119-20-47	17.170	-8.415	14.967	-110775.554	-4572.402	13.939	-117.296685
KH123	KH124	258-37-14	197-58-01	13.356	-12.705	-4.120	-110788.259	-4576.522	24.786	-314.906130
KH124	D11	161-39-08	179-37-09	2.106	-2.106	0.014	-110790.365	-4576.508	20.680	-43.552080
D11	K18-9	121-45-20	121-22-29	5.883	-3.063	5.023	-110793.428	-4571.485	25.717	-78.771171
K18-9	K18-8	180-10-29	121-32-58	1.745	-0.913	1.487	-110794.341	-4569.998	32.227	-29.423251
K18-8	K18-7	180-23-59	121-56-57	0.648	-0.343	0.550	-110794.684	-4569.448	34.264	-11.752552
K18-7	K18-6	180-02-34	121-59-31	4.492	-2.380	3.810	-110797.064	-4565.638	38.624	-91.925120
K18-6	G18-5	179-59-16	121-58-47	27.152	-14.380	23.031	-110811.444	-4542.607	65.465	-941.386700
G18-5	G18-4	225-51-55	167-50-42	2.793	-2.730	0.588	-110814.174	-4542.019	89.084	-243.199320
G18-4	D10	225-23-40	213-14-22	1.058	-0.885	-0.580	-110815.059	-4542.599	89.092	-78.846420
D10	G24-1	90-01-33	123-15-55	4.002	-2.195	3.346	-110817.254	-4539.253	91.858	-201.628310
G24-1	NH15	178-39-20	121-55-15	0.216	-0.114	0.183	-110817.368	-4539.070	95.387	-10.874118
NH15	J2	86-55-20	28-50-35	22.659	19.848	10.931	-110797.520	-4528.139	106.501	2113.831848
J2	J4	93-39-23	302-29-58	4.044	2.173	-3.411	-110795.347	-4531.550	114.021	247.767633
J4	G19-13	89-32-59	212-02-57	1.530	-1.297	-0.812	-110796.644	-4532.362	109.798	-142.408006
G19-13	G19-12	225-40-42	257-43-39	2.884	-0.613	-2.818	-110797.257	-4535.180	106.168	-65.080984
G19-12	G19-11	224-14-44	301-58-23	20.067	10.626	-17.023	-110786.631	-4552.203	86.327	917.310702
G19-11	G19-10	179-51-40	301-50-03	2.484	1.310	-2.110	-110785.321	-4554.313	67.194	88.024140
G19-10	G19-9	180-21-22	302-11-25	7.852	4.183	-6.645	-110781.138	-4560.958	58.439	244.450337
G19-9	G19-8	179-55-28	302-06-53	0.666	0.354	-0.564	-110780.784	-4561.522	51.230	18.135420
G19-8	G19-7	179-35-20	301-42-13	6.297	3.309	-5.357	-110777.475	-4566.879	45.309	149.927481
G19-7	G19-17	179-00-28	300-42-41	6.309	3.222	-5.424	-110774.253	-4572.303	34.528	111.249216
G19-17	G19-6	179-55-17	300-37-58	1.128	0.575	-0.971	-110773.678	-4573.274	28.133	16.176475
G19-6	D12	178-11-21	298-49-19	15.501	7.473	-13.581	-110766.205	-4586.855	13.581	101.490813

倍面積	1637.793294
面積	818.8966470
坪數	247.71

* * 面積計算 (倍横距法) * *

地 器械点	番： 視準点	野路平野線(1) 内角	方向角	距離	緯距	經距	X座標	Y座標	倍横距	倍面積
G1-8	G1-7	81-45-23	302-03-06	48.168	25.562	-40.826	-110869.107	-4227.099	-40.826	-1043.594212
G1-7	G1-6	174-14-01	296-17-07	11.451	5.071	-10.267	-110864.036	-4237.366	-91.919	-466.121249
G1-6	G1-5	180-00-10	296-17-17	11.836	5.242	-10.612	-110858.794	-4247.978	-112.798	-591.287116
G1-5	G9-9	183-18-08	299-35-25	16.262	8.030	-14.141	-110850.764	-4262.119	-137.551	-1104.534530
G9-9	K9-22	182-25-42	302-01-07	22.299	11.823	-18.907	-110838.941	-4281.026	-170.599	-2016.991977
K9-22	K9-20	179-58-31	301-59-38	1.584	0.839	-1.343	-110838.102	-4282.369	-190.849	-160.122311
K9-20	G9-8	180-04-25	302-04-03	0.392	0.208	-0.332	-110837.894	-4282.701	-192.524	-40.044992
G9-8	G9-7	179-56-03	302-00-06	9.695	5.138	-8.222	-110832.756	-4290.923	-201.078	-1033.138764
G9-7	G9-6	179-59-08	301-59-14	14.352	7.603	-12.173	-110825.153	-4303.096	-221.473	-1683.814924
G9-6	B9-2	179-57-31	301-56-45	11.186	5.918	-9.492	-110819.235	-4312.588	-243.138	-1438.997137
B9-2	G9-5	180-01-11	301-57-56	5.367	2.841	-4.553	-110816.394	-4317.141	-257.182	-730.715752
G9-5	K9-24	180-06-21	302-04-17	13.103	6.958	-11.103	-110809.436	-4328.244	-272.839	-1898.276689
K9-24	G9-4	180-00-00	302-04-17	14.914	7.919	-12.638	-110801.517	-4340.882	-296.580	-2348.617020
G9-4	G14-15	179-58-56	302-03-13	12.498	6.633	-10.593	-110794.884	-4351.475	-319.811	-2121.306363
G14-15	G14-14	179-53-00	301-56-13	5.494	2.906	-4.662	-110791.978	-4356.137	-335.066	-973.701796
G14-14	G14-13	90-06-18	212-02-31	14.398	-12.205	-7.639	-110804.183	-4363.776	-347.367	4239.614235
G14-13	G14-12	180-00-12	212-02-43	18.824	-15.956	-9.988	-110820.139	-4373.764	-364.994	5823.844264
G14-12	G14-11	179-46-56	211-49-39	1.434	-1.218	-0.756	-110821.357	-4374.520	-375.738	457.648884
G14-11	G14-10	180-12-12	212-01-51	19.156	-16.240	-10.160	-110837.597	-4384.680	-386.654	6279.260960
G14-10	G15-8	179-52-48	211-54-39	14.079	-11.951	-7.442	-110849.548	-4392.122	-404.256	4831.263456
G15-8	G15-7	180-06-43	212-01-22	24.394	-20.682	-12.935	-110870.230	-4405.057	-424.633	8782.259706
G15-7	G16-8	180-00-21	212-01-43	30.132	-25.545	-15.980	-110895.775	-4421.037	-453.548	11585.883660
G16-8	K6-2	77-58-19	110-00-02	20.440	-6.991	19.207	-110902.766	-4401.830	-450.321	3148.194111
K6-2	G6-1	146-36-14	76-36-16	5.033	1.166	4.896	-110901.600	-4396.934	-426.218	-496.970188
G6-1	G8-9	135-38-02	32-14-18	14.988	12.677	7.995	-110888.923	-4388.939	-413.327	-5239.746379
G8-9	G8-8	134-12-40	346-26-58	5.006	4.867	-1.173	-110884.056	-4390.112	-406.505	-1978.459835
G8-8	K8-13	225-37-57	32-04-55	15.695	13.298	8.336	-110870.758	-4381.776	-399.342	-5310.449916

器械点	視準点	内角	方向角	距離	緯距	經距	X座標	Y座標	倍橫距	倍面積
K8-13	G8-6	179-55-04	31-59-59	18.590	15.765	9.851	-110854.993	-4371.925	-381.155	-6008.908575
G8-6	KE8-4	180-01-15	32-01-14	14.022	11.889	7.435	-110843.104	-4364.490	-363.869	-4326.038541
KE8-4	KE8-3	180-15-23	32-16-37	1.991	1.683	1.063	-110841.421	-4363.427	-355.371	-598.089393
KE8-3	G8-5	179-34-05	31-50-42	3.178	2.700	1.677	-110838.721	-4361.750	-352.631	-952.103700
G8-5	G8-2-1	225-10-54	77-01-36	14.552	3.267	14.181	-110835.454	-4347.569	-336.773	-1100.237391
G8-2-1	G8-2	179-40-21	76-41-57	1.304	0.300	1.269	-110835.154	-4346.300	-321.323	-96.396900
G8-2	G8-1	180-21-30	77-03-27	16.123	3.611	15.713	-110831.543	-4330.587	-304.341	-1098.975351
G8-1	G8-22	224-56-39	122-00-06	6.693	-3.547	5.676	-110835.090	-4324.911	-282.952	1003.630744
G8-22	K8-5	180-04-34	122-04-40	1.341	-0.712	1.136	-110835.802	-4323.775	-276.140	196.611680
K8-5	G8-21	179-58-45	122-03-25	15.229	-8.083	12.907	-110843.885	-4310.868	-262.097	2118.530051
G8-21	G7-26	179-57-29	122-00-54	13.104	-6.947	11.111	-110850.832	-4299.757	-238.079	1653.934813
G7-26	K7-29	179-56-25	121-57-19	14.329	-7.584	12.158	-110858.416	-4287.599	-214.810	1629.119040
K7-29	G7-27	179-57-44	121-55-03	0.968	-0.512	0.822	-110858.928	-4286.777	-201.830	103.336960
G7-27	G7-1	180-04-59	122-00-02	16.576	-8.784	14.057	-110867.712	-4272.720	-186.951	1642.177584
G7-1	G2-1	180-04-29	122-04-31	16.082	-8.540	13.627	-110876.252	-4259.093	-159.267	1360.140180
G2-1	G2-31	179-55-23	121-59-54	31.867	-16.886	27.025	-110893.138	-4232.068	-118.615	2002.932890
G2-31	K2-41	179-59-30	121-59-24	3.562	-1.887	3.021	-110895.025	-4229.047	-88.569	167.129703
K2-41	K2-40	179-59-42	121-59-06	3.561	-1.886	3.020	-110896.911	-4226.027	-82.528	155.647808
K2-40	G2-30	179-59-42	121-58-48	4.554	-2.412	3.863	-110899.323	-4222.164	-75.645	182.455740
G2-30	G2-32	180-04-49	122-03-37	14.295	-7.588	12.115	-110906.911	-4210.049	-59.667	452.753196
G2-32	G2-29	179-48-23	121-52-00	10.329	-5.453	8.772	-110912.364	-4201.277	-38.780	211.467340
G2-29	G1-8	98-25-43	40-17-43	23.200	17.695	15.004	-110894.669	-4186.273	-15.004	-265.495780
									倍面積	12904.700224
									面積	6452.3501120
									坪数	1951.83

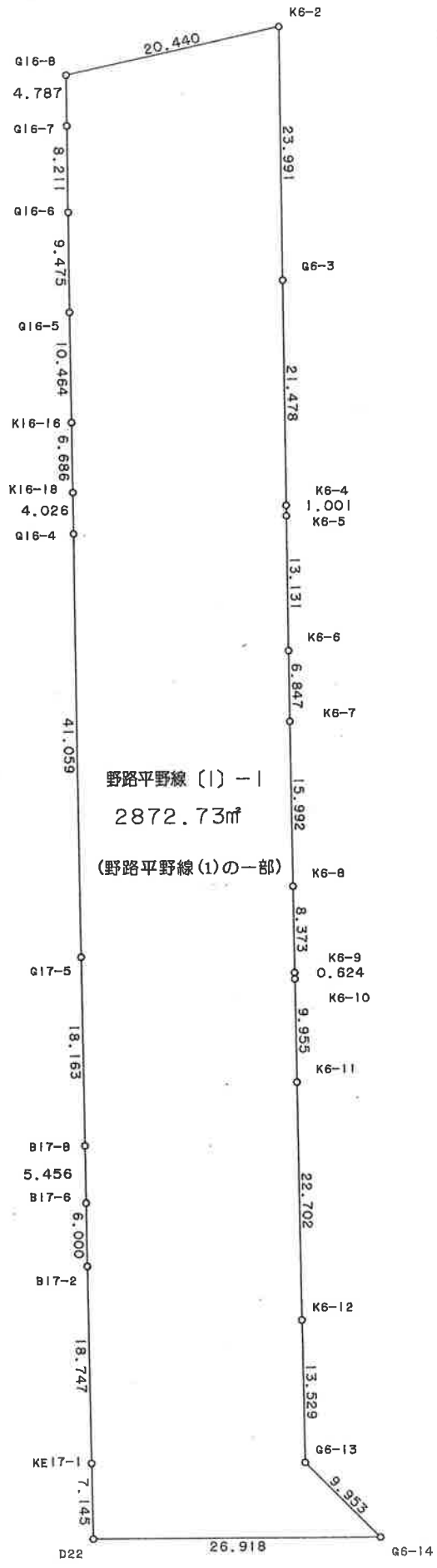
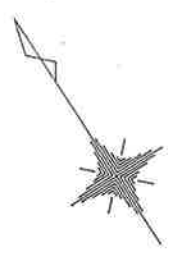

* * 面積計算 (倍横距法) * *

地 器械点	番 : 視準点	野路平野線(1)-1 内角	方向	距離	緯距	經距	X座標	Y座標	倍横距	倍面積
G16-8	G16-7	101-58-23	211-58-25	4.787	-4.061	-2.535	-110899.836	-4423.572	-2.535	10.294635
G16-7	G16-6	180-02-53	212-01-18	8.211	-6.962	-4.354	-110906.798	-4427.926	-9.424	65.609888
G16-6	G16-5	180-01-41	212-02-59	9.475	-8.031	-5.028	-110914.829	-4432.954	-18.806	151.030986
G16-5	K16-16	179-52-42	211-55-41	10.464	-8.881	-5.534	-110923.710	-4438.488	-29.368	260.817208
K16-16	K16-18	179-59-54	211-55-35	6.686	-5.675	-3.536	-110929.385	-4442.024	-38.438	218.135650
K16-18	G16-4	179-59-57	211-55-32	4.026	-3.417	-2.129	-110932.802	-4444.153	-44.103	150.699951
G16-4	G17-5	180-05-34	212-01-06	41.059	-34.813	-21.769	-110967.615	-4465.922	-68.001	2367.318813
G17-5	B17-8	179-59-44	212-00-50	18.163	-15.401	-9.629	-110983.016	-4475.551	-99.399	1530.813553
B17-8	B17-6	180-00-00	212-00-50	5.456	-4.626	-2.892	-110987.642	-4478.443	-111.920	517.768304
B17-6	B17-2	180-00-17	212-01-07	6.000	-5.087	-3.181	-110992.729	-4481.624	-117.993	600.230391
B17-2	KE17-1	179-59-40	212-00-47	18.747	-15.896	-9.938	-111008.625	-4491.562	-131.112	2084.156352
KE17-1	D22	179-59-35	212-00-42	7.145	-6.059	-3.787	-111014.684	-4495.349	-144.837	877.567383
D22	G6-14	90-38-50	122-39-12	26.918	-14.524	22.664	-111029.208	-4472.685	-125.960	1829.443040
G6-14	G6-13	45-18-47	347-57-59	9.953	9.734	-2.075	-111019.474	-4474.760	-105.371	-1025.681314
G6-13	K6-12	224-01-59	31-59-58	13.529	11.473	7.169	-111008.001	-4467.591	-100.277	-1150.478021
K6-12	K6-11	180-00-15	32-00-13	22.702	19.252	12.032	-110988.749	-4455.559	-81.076	-1560.876134
K6-11	K6-10	179-59-44	31-59-57	9.955	8.442	5.275	-110980.307	-4450.284	-63.770	-538.343021
K6-10	K6-9	180-02-07	32-02-04	0.624	0.529	0.331	-110979.778	-4449.953	-58.164	-30.768549
K6-9	K6-8	179-58-14	32-00-18	8.373	7.101	4.438	-110972.677	-4445.516	-53.395	-379.133032
K6-8	K6-7	179-59-37	31-59-55	15.992	13.562	8.474	-110959.115	-4437.042	-40.483	-549.030446
K6-7	K6-6	180-01-10	32-01-05	6.847	5.805	3.630	-110953.310	-4433.411	-28.379	-164.751429
K6-6	K6-5	180-00-06	32-01-11	13.131	11.133	6.962	-110942.177	-4426.449	-17.787	-198.018310
K6-5	K6-4	180-02-03	32-03-14	1.001	0.848	0.531	-110941.329	-4425.918	-10.294	-8.728979
K6-4	G6-3	179-58-35	32-01-09	21.478	18.208	11.391	-110923.121	-4414.527	1.628	29.649755
G6-3	K6-2	179-55-31	31-57-10	23.991	20.355	12.697	-110902.766	-4401.830	25.717	523.464886
K6-2	G16-8	78-02-42	290-00-02	20.440	6.991	-19.207	-110895.775	-4421.037	19.207	134.276137

倍面積	5745.467699
面積	2872.7338494
坪數	869.00

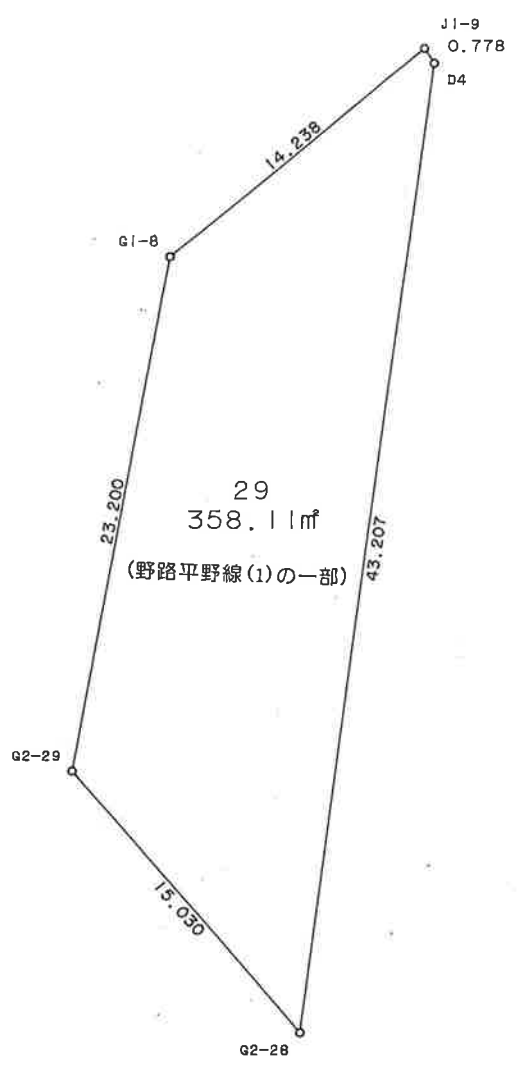
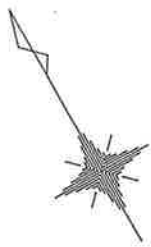

* * 面積計算 (倍橫距法) * *

地 器械点	番 : 29 視準点	内角	方向角	距離	緯距	經距	X座標	Y座標	倍橫距	倍面積
J1-9	G1-8	83-53-18	259-54-28	14.238	-2.495	-14.018	-110894.669	-4186.273	-14.018	34.974910
G1-8	G2-29	140-23-15	220-17-43	23.200	-17.695	-15.004	-110912.364	-4201.277	-43.040	761.592800
G2-29	G2-28	129-26-43	169-44-26	15.030	-14.790	2.677	-110927.154	-4198.600	-55.367	818.877930
G2-28	D4	47-55-15	37-39-41	43.207	34.204	26.399	-110892.950	-4172.201	-26.291	-899.257364
D4	J1-9	138-21-29	356-01-10	0.778	0.776	-0.054	-110892.174	-4172.255	0.054	0.041904
									倍面積	716.230180
									面積	358.1150900
									坪数	108.32

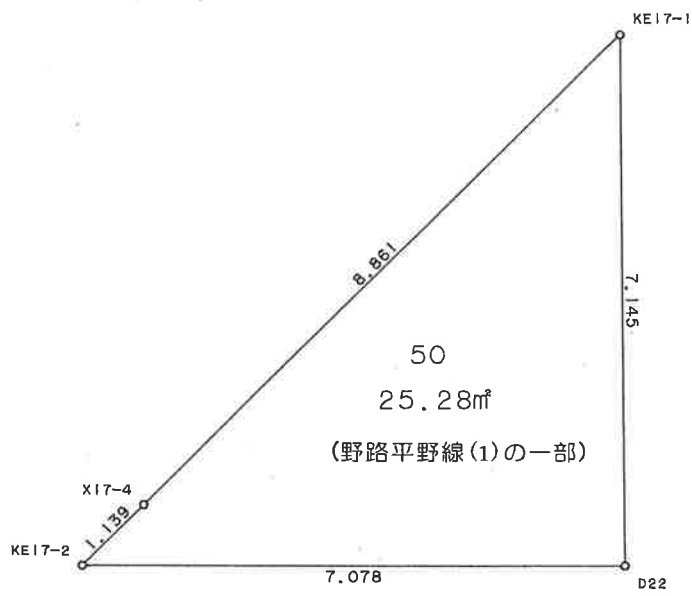
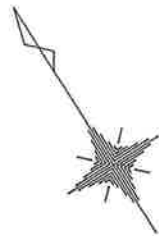

* * 面積計算 (倍橫距法) * *

地 器械点	番 : 視準点	50 内角	方向角	距離	緯距	經距	X座標	Y座標	倍橫距	倍面積
KE17-1	X17-4	45-03-00	257-03-22	8.861	-1.985	-8.636	-111010.610	-4500.198	-8.636	17.141194
X17-4	KE17-2	180-00-00	257-03-22	1.139	-0.255	-1.110	-111010.865	-4501.308	-18.382	4.689846
KE17-2	D22	45-35-56	122-39-18	7.078	-3.819	5.959	-111014.684	-4495.349	-13.533	51.682527
D22	KE17-1	89-21-04	32-00-22	7.145	6.059	3.787	-111008.625	-4491.562	-3.787	-22.945433
									倍面積	50.568134
									面積	25.2840670
									坪數	7.64

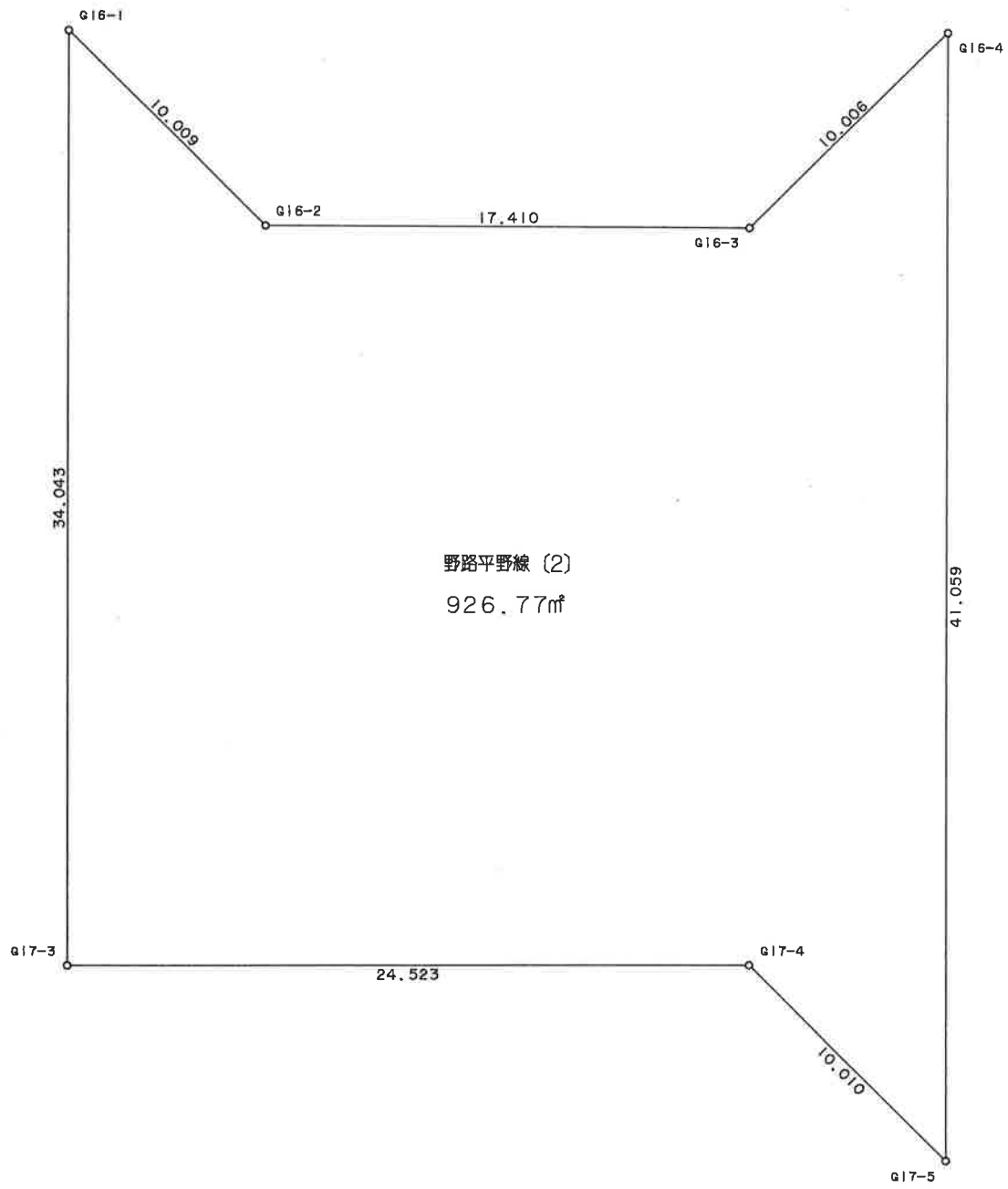

* * 面積計算 (倍横距法) * *

地 器械点	番： 視準点	野路平野線(2) 内角	方向角	距離	緯距	經距	X座標	Y座標	倍横距	倍面積
G16-1	G17-3	45-14-56	211-57-30	34.043	-28.883	-18.019	-110944.876	-4488.954	-18.019	520.442777
G17-3	G17-4	90-00-00	121-57-30	24.523	-12.980	20.806	-110957.856	-4468.148	-15.232	197.711360
G17-4	G17-5	225-11-33	167-09-03	10.010	-9.759	2.226	-110967.615	-4465.922	7.800	-76.120200
G17-5	G16-4	44-52-03	32-01-06	41.059	34.813	21.769	-110932.802	-4444.153	31.795	1106.879335
G16-4	G16-3	45-09-24	257-10-30	10.006	-2.221	-9.756	-110935.023	-4453.909	43.808	-97.297568
G16-3	G16-2	225-04-12	302-14-42	17.410	9.289	-14.725	-110925.734	-4468.634	19.327	179.528503
G16-2	G16-1	224-27-52	346-42-34	10.009	9.741	-2.301	-110915.993	-4470.935	2.301	22.414041
									倍面積	1853.558248
									面積	926.7791240
									坪数	280.35

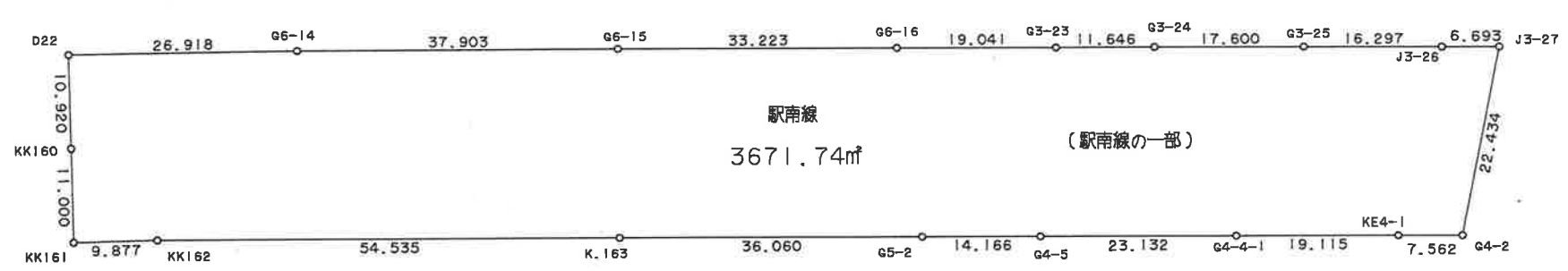
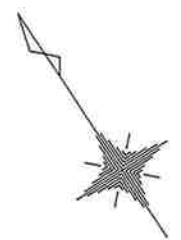

* * 面積計算 (倍横距法) * *

地 器械点	番 : 視準点	内角	方向角	距離	緯距	經距	X座標	Y座標	倍横距	倍面積
J3-27	J3-26	78-44-47	303-19-19	6.693	3.677	-5.593	-111103.750	-4359.281	-5.593	-20.565461
J3-26	G3-25	180-05-11	303-24-30	16.297	8.973	-13.604	-111094.777	-4372.885	-24.790	-222.440670
G3-25	G3-24	179-56-48	303-21-18	17.600	9.677	-14.701	-111085.100	-4387.586	-53.095	-513.800315
G3-24	G3-23	179-51-32	303-12-50	11.646	6.379	-9.743	-111078.721	-4397.329	-77.539	-494.621281
G3-23	G6-16	180-07-59	303-20-49	19.041	10.467	-15.906	-111068.254	-4413.235	-103.188	-1080.068796
G6-16	G6-15	180-00-59	303-21-48	33.223	18.271	-27.748	-111049.983	-4440.983	-146.842	-2682.950182
G6-15	G6-14	179-52-28	303-14-16	37.903	20.775	-31.702	-111029.208	-4472.685	-206.292	-4285.716300
G6-14	D22	179-24-56	302-39-12	26.918	14.524	-22.664	-111014.684	-4495.349	-260.658	-3785.796792
D22	KK160	89-21-57	212-01-09	10.920	-9.259	-5.790	-111023.943	-4501.139	-289.112	2676.888008
KK160	KK161	179-59-52	212-01-01	11.000	-9.327	-5.832	-111033.270	-4506.971	-300.734	2804.946018
KK161	KK162	89-56-12	121-57-13	9.877	-5.227	8.380	-111038.497	-4498.591	-298.186	1558.618222
KK162	K.163	181-21-41	123-18-54	54.535	-29.953	45.573	-111068.450	-4453.018	-244.233	7315.511049
K.163	G5-2	180-01-40	123-20-34	36.060	-19.820	30.124	-111088.270	-4422.894	-168.536	3340.383520
G5-2	G4-5	179-59-06	123-19-40	14.166	-7.783	11.836	-111096.053	-4411.058	-126.576	985.141008
G4-5	G4-4-1	179-57-47	123-17-27	23.132	-12.697	19.336	-111108.750	-4391.722	-95.404	1211.344588
G4-4-1	KE4-1	180-02-12	123-19-39	19.115	-10.502	15.971	-111119.252	-4375.751	-60.097	631.138694
KE4-1	G4-2	180-00-12	123-19-51	7.562	-4.155	6.318	-111123.407	-4369.433	-37.808	157.092240
G4-2	J3-27	101-14-41	44-34-32	22.434	15.980	15.745	-111107.427	-4353.688	-15.745	-251.605100
									倍面積	7343.498450
									面積	3671.7492250
									坪数	1110.70

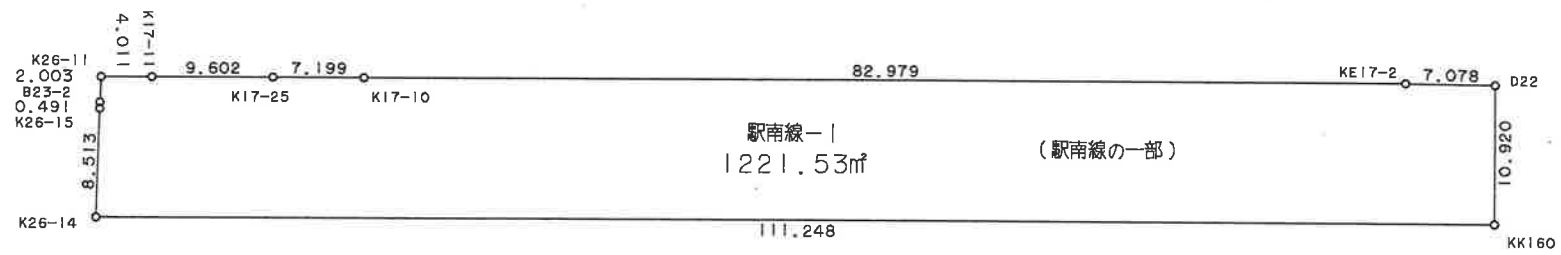
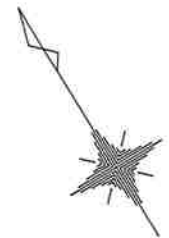

* * 面積計算 (倍横距法) * *

地 器械点	番 : 視準点	内角	方向角	距離	緯距	經距	X座標	Y座標	倍横距	倍面積
K26-11	B23-2	92-31-59	214-31-24	2.003	-1.650	-1.135	-110957.501	-4590.455	-1.135	1.872750
B23-2	K26-15	179-56-35	214-27-59	0.491	-0.405	-0.278	-110957.906	-4590.733	-2.548	1.031940
K26-15	K26-14	179-22-30	213-50-29	8.513	-7.071	-4.741	-110964.977	-4595.474	-7.567	53.506257
K26-14	KK160	88-10-01	122-00-30	111.248	-58.966	94.335	-111023.943	-4501.139	82.027	-4836.804082
KK160	D22	90-00-39	32-01-09	10.920	9.259	5.790	-111014.684	-4495.349	182.152	1686.545368
D22	KE17-2	90-38-09	302-39-18	7.078	3.819	-5.959	-111010.865	-4501.308	181.983	694.993077
KE17-2	K17-10	179-21-11	302-00-29	82.979	43.982	-70.364	-110966.883	-4571.672	105.660	4647.138120
K17-10	K17-25	180-02-22	302-02-51	7.199	3.820	-6.102	-110963.063	-4577.774	29.194	111.521080
K17-25	K17-11	179-56-34	301-59-25	9.602	5.087	-8.144	-110957.976	-4585.918	14.948	76.040476
K17-11	K26-11	180-00-00	301-59-25	4.011	2.125	-3.402	-110955.851	-4589.320	3.402	7.229250
									倍面積	2443.074236
									面積	1221.5371180
									坪数	369.51

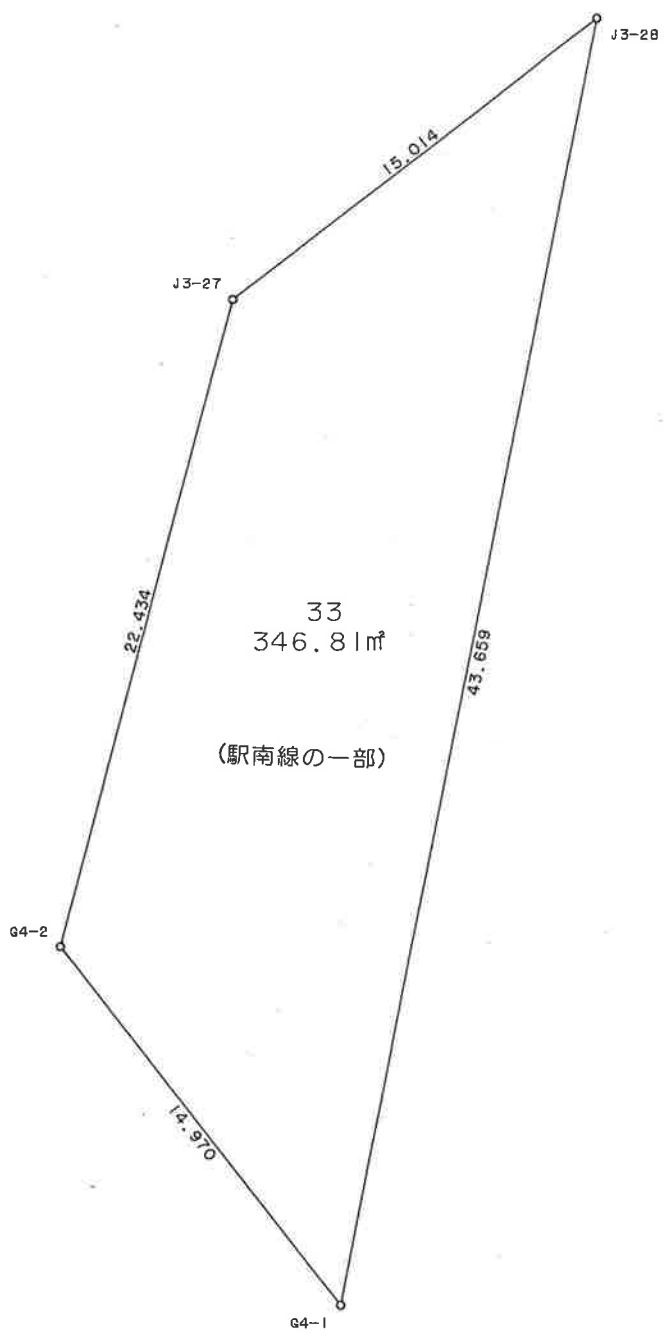
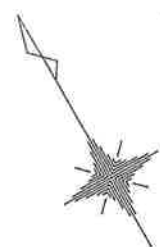

* * 面積計算 (倍橫距法) * *

地 器械点	番 : 33 視準点	内角	方向角	距離	緯距	經距	X座標	Y座標	倍橫距	倍面積
J3-28	J3-27	40-48-04	261-45-47	15.014	-2.151	-14.859	-111107.427	-4353.688	-14.859	31.961709
J3-27	G4-2	142-48-45	224-34-32	22.434	-15.980	-15.745	-111123.407	-4369.433	-45.463	726.498740
G4-2	G4-1	127-48-44	172-23-16	14.970	-14.838	1.983	-111138.245	-4367.450	-59.225	878.780550
G4-1	J3-28	48-34-27	40-57-43	43.659	32.969	28.621	-111105.276	-4338.829	-28.621	-943.605749
									倍面積	693.635250
									面積	346.8176250
									坪數	104.91

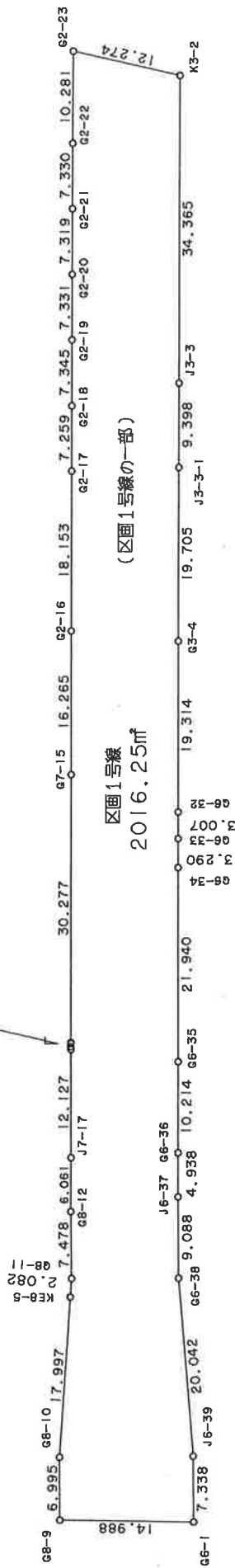
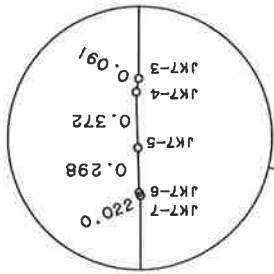
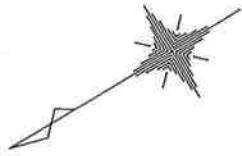

区画1号線
 2016.25㎡
 (区画1号線の一部)

* * 面積計算 (倍横距法) * *

地 器械点	番 視準点	区画1号線 内角	方向角	距離	緯距	經距	X座標	Y座標	倍横距	倍面積
G2-23	G2-22	77-34-22	301-35-09	10.281	5.385	-8.758	-110970.639	-4257.515	-8.758	-47.161830
G2-22	G2-21	179-51-28	301-26-37	7.330	3.824	-6.254	-110966.815	-4263.769	-23.770	-90.896480
G2-21	G2-20	179-56-16	301-22-53	7.319	3.811	-6.248	-110963.004	-4270.017	-36.272	-138.232592
G2-20	G2-19	179-59-43	301-22-36	7.331	3.817	-6.259	-110959.187	-4276.276	-48.779	-186.189443
G2-19	G2-18	180-00-55	301-23-31	7.345	3.826	-6.270	-110955.361	-4282.546	-61.308	-234.564408
G2-18	G2-17	180-05-20	301-28-51	7.259	3.791	-6.191	-110951.570	-4288.737	-73.769	-279.658279
G2-17	G2-16	179-55-38	301-24-29	18.153	9.460	-15.493	-110942.110	-4304.230	-95.453	-902.985380
G2-16	G7-15	179-57-29	301-21-58	16.265	8.466	-13.888	-110933.644	-4318.118	-124.834	-1056.844644
G7-15	JK7-3	180-04-22	301-26-20	30.277	15.792	-25.832	-110917.852	-4343.950	-164.554	-2598.636768
JK7-3	JK7-4	190-27-18	311-53-38	0.091	0.061	-0.068	-110917.791	-4344.018	-190.454	-11.617694
JK7-4	JK7-5	167-46-28	299-40-06	0.372	0.184	-0.323	-110917.607	-4344.341	-190.845	-35.115480
JK7-5	JK7-6	180-04-36	299-44-42	0.298	0.148	-0.259	-110917.459	-4344.600	-191.427	-28.331196
JK7-6	JK7-7	158-01-13	277-45-55	0.022	0.003	-0.022	-110917.456	-4344.622	-191.708	-0.575124
JK7-7	J7-17	203-35-35	301-21-30	12.127	6.311	-10.356	-110911.145	-4354.978	-202.086	-1275.364746
J7-17	G8-12	180-10-05	301-31-35	6.061	3.169	-5.166	-110907.976	-4360.144	-217.608	-689.599752
G8-12	G8-11	179-20-10	300-51-45	7.478	3.836	-6.419	-110904.140	-4366.563	-229.193	-879.184348
G8-11	KE8-5	184-26-18	305-18-03	2.082	1.203	-1.699	-110902.937	-4368.262	-237.311	-285.485133
KE8-5	G8-10	179-59-35	305-17-38	17.997	10.398	-14.689	-110892.539	-4382.951	-253.699	-2637.962202
G8-10	G8-9	175-49-58	301-07-36	6.995	3.616	-5.988	-110888.923	-4388.939	-274.376	-992.143616
G8-9	G6-1	91-06-42	212-14-18	14.988	-12.677	-7.995	-110901.600	-4396.934	-288.359	3655.527043
G6-1	J6-39	88-45-32	120-59-50	7.338	-3.779	6.290	-110905.379	-4390.644	-290.064	1096.151856
J6-39	G6-38	175-44-58	116-44-48	20.042	-9.020	17.898	-110914.399	-4372.746	-265.876	2398.201520
G6-38	J6-37	184-19-23	121-04-11	9.088	-4.690	7.784	-110919.089	-4364.962	-240.194	1126.509860
J6-37	G6-36	180-20-52	121-25-03	4.938	-2.574	4.214	-110921.663	-4360.748	-228.196	587.376504
G6-36	G6-35	180-00-36	121-25-39	10.214	-5.326	8.716	-110926.989	-4352.032	-215.266	1146.506716
G6-35	G6-34	179-58-13	121-23-52	21.940	-11.430	18.727	-110938.419	-4333.305	-187.823	2146.816890
G6-34	G6-33	180-06-13	121-30-05	3.290	-1.719	2.805	-110940.138	-4330.500	-166.291	285.854229

器械点	視準点	内角	方向角	距離	緯距	經距	X座標	Y座標	倍橫距	倍面積
G6-33	G6-32	179-59-42	121-29-47	3.007	-1.571	2.564	-110941.709	-4327.936	-160.922	252.808462
G6-32	G3-4	179-51-20	121-21-07	19.314	-10.049	16.494	-110951.758	-4311.442	-141.864	1425.591336
G3-4	J3-3-1	180-05-53	121-27-00	19.705	-10.281	16.810	-110962.039	-4294.632	-108.560	1116.105360
J3-3-1	J3-3	179-56-48	121-23-48	9.398	-4.896	8.022	-110966.935	-4286.610	-83.728	409.932288
J3-3	K3-2	180-01-34	121-25-22	34.365	-17.916	29.325	-110984.851	-4257.285	-46.381	830.961996
K3-2	G2-23	102-35-25	44-00-47	12.274	8.827	8.528	-110976.024	-4248.757	-8.528	-75.276656
									倍面積	4032.518289
									面積	2016.2591445
									坪数	609.91

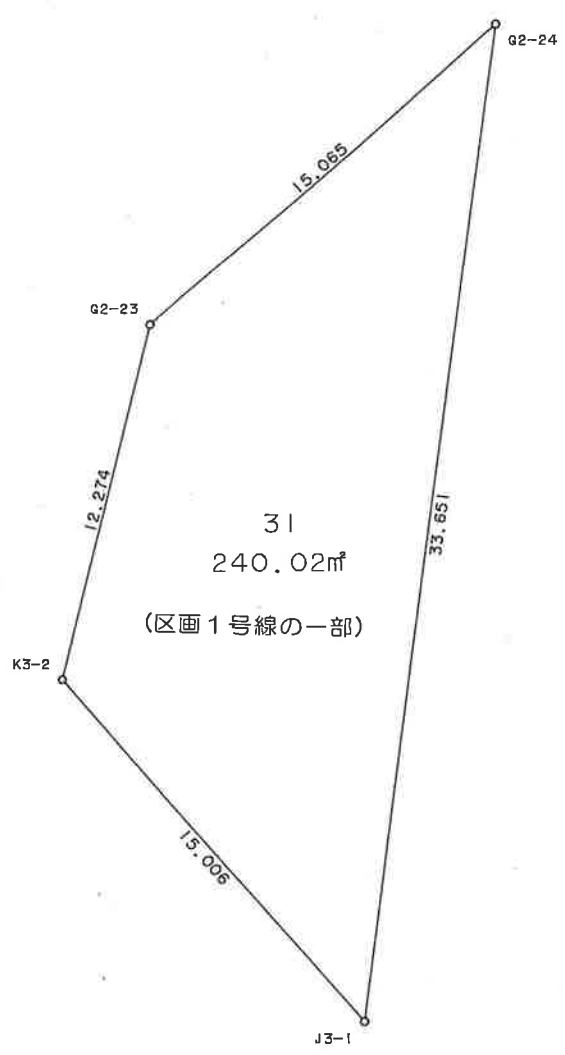
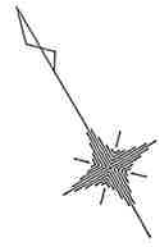

* * 面積計算 (倍橫距法) * *

地 器械点	番 : 31 視準点	内角	方向角	距離	緯距	經距	X座標	Y座標	倍橫距	倍面積
G2-24	G2-23	40-39-17	258-20-33	15.065	-3.044	-14.754	-110976.024	-4248.757	-14.754	44.911176
G2-23	K3-2	145-40-14	224-00-47	12.274	-8.827	-8.528	-110984.851	-4257.285	-38.036	335.743772
K3-2	J3-1	125-35-10	169-35-57	15.006	-14.759	2.709	-110999.610	-4254.576	-43.855	647.255945
J3-1	G2-24	48-05-19	37-41-16	33.651	26.630	20.573	-110972.980	-4234.003	-20.573	-547.858990
									倍面積	480.051903
									面積	240.0259515
									坪数	72.60

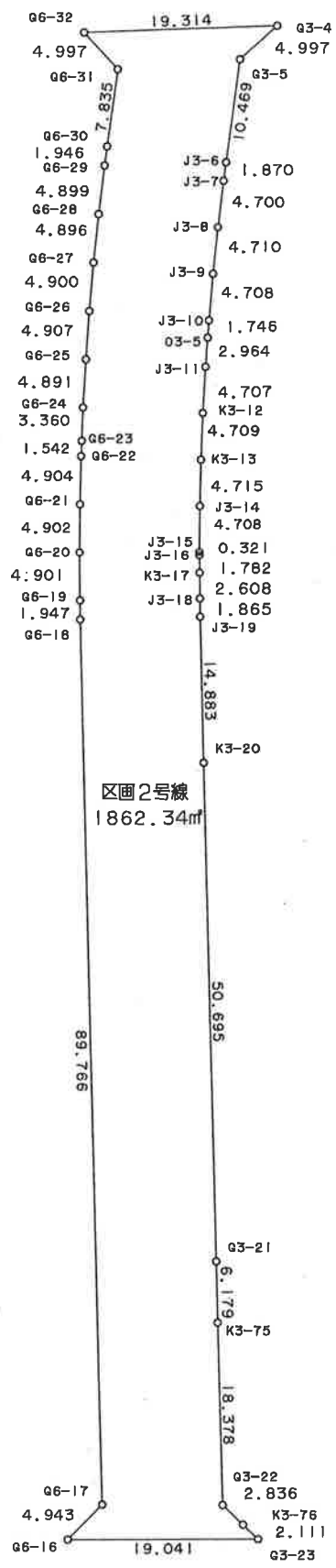
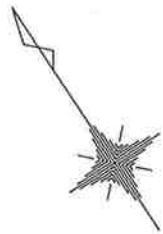

* * 面積計算 (倍横距法) * *

地 器械点	番 : 視準点	区画 2 号線 内角	方向角	距離	緯距	經距	X座標	Y座標	倍横距	倍面積
G6-32	G6-31	49-36-35	170-57-42	4.997	-4.935	0.785	-110946.644	-4327.151	0.785	-3.873975
G6-31	G6-30	230-04-27	221-02-09	7.835	-5.910	-5.144	-110952.554	-4332.295	-3.574	21.122340
G6-30	G6-29	179-56-32	220-58-41	1.946	-1.469	-1.276	-110954.023	-4333.571	-9.994	14.681186
G6-29	G6-28	179-10-41	220-09-22	4.899	-3.744	-3.159	-110957.767	-4336.730	-14.429	54.022176
G6-28	G6-27	179-02-28	219-11-50	4.896	-3.794	-3.094	-110961.561	-4339.824	-20.682	78.467508
G6-27	G6-26	179-06-56	218-18-46	4.900	-3.845	-3.038	-110965.406	-4342.862	-26.814	103.099830
G6-26	G6-25	178-50-06	217-08-52	4.907	-3.911	-2.963	-110969.317	-4345.825	-32.815	128.339465
G6-25	G6-24	179-40-56	216-49-48	4.891	-3.915	-2.932	-110973.232	-4348.757	-38.710	151.549650
G6-24	G6-23	178-44-50	215-34-38	3.360	-2.733	-1.955	-110975.965	-4350.712	-43.597	119.150601
G6-23	G6-22	179-53-44	215-28-22	1.542	-1.256	-0.895	-110977.221	-4351.607	-46.447	58.337432
G6-22	G6-21	179-15-39	214-44-01	4.904	-4.030	-2.794	-110981.251	-4354.401	-50.136	202.048080
G6-21	G6-20	178-56-37	213-40-38	4.902	-4.079	-2.718	-110985.330	-4357.119	-55.648	226.988192
G6-20	G6-19	179-08-15	212-48-53	4.901	-4.119	-2.656	-110989.449	-4359.775	-61.022	251.349618
G6-19	G6-18	179-34-39	212-23-32	1.947	-1.644	-1.043	-110991.093	-4360.818	-64.721	106.401324
G6-18	G6-17	179-37-15	212-00-47	89.766	-76.115	-47.586	-111067.208	-4408.404	-113.350	8627.635250
G6-17	G6-16	225-46-12	257-46-59	4.943	-1.046	-4.831	-111068.254	-4413.235	-165.767	173.392282
G6-16	G3-23	45-33-50	123-20-49	19.041	-10.467	15.906	-111078.721	-4397.329	-154.692	1619.161164
G3-23	K3-76	44-10-38	347-31-27	2.111	2.061	-0.456	-111076.660	-4397.785	-139.242	-286.977762
K3-76	G3-22	179-59-35	347-31-02	2.836	2.769	-0.613	-111073.891	-4398.398	-140.311	-388.521159
G3-22	K3-75	224-24-25	31-55-27	18.378	15.598	9.718	-111058.293	-4388.680	-131.206	-2046.551188
K3-75	G3-21	180-00-23	31-55-50	6.179	5.244	3.268	-111053.049	-4385.412	-118.220	-619.945680
G3-21	K3-20	180-04-32	32-00-22	50.695	42.989	26.869	-111010.060	-4358.543	-88.083	-3786.600087
K3-20	J3-19	180-01-55	32-02-17	14.883	12.616	7.895	-110997.444	-4350.648	-53.319	-672.672504
J3-19	J3-18	180-35-44	32-38-01	1.865	1.571	1.006	-110995.873	-4349.642	-44.418	-69.780678
J3-18	K3-17	179-59-46	32-37-47	2.608	2.196	1.406	-110993.677	-4348.236	-42.006	-92.245176
K3-17	J3-16	180-12-15	32-50-02	1.782	1.497	0.966	-110992.180	-4347.270	-39.634	-59.332098
J3-16	J3-15	180-12-45	33-02-47	0.321	0.269	0.175	-110991.911	-4347.095	-38.493	-10.354617

器械点	視準点	内角	方向角	距離	緯距	經距	X座標	Y座標	倍橫距	倍面積
J3-15	J3-14	180-40-39	33-43-26	4.708	3.916	2.614	-110987.995	-4344.481	-35.704	-139.816864
J3-14	K3-13	180-58-39	34-42-05	4.715	3.876	2.684	-110984.119	-4341.797	-30.406	-117.853656
K3-13	K3-12	180-55-47	35-37-52	4.709	3.827	2.743	-110980.292	-4339.054	-24.979	-95.594633
K3-12	J3-11	180-54-45	36-32-37	4.707	3.782	2.803	-110976.510	-4336.251	-19.433	-73.495606
J3-11	O3-5	181-00-52	37-33-29	2.964	2.350	1.807	-110974.160	-4334.444	-14.823	-34.834050
O3-5	J3-10	180-01-14	37-34-43	1.746	1.384	1.065	-110972.776	-4333.379	-11.951	-16.540184
J3-10	J3-9	180-33-17	38-08-00	4.708	3.703	2.907	-110969.073	-4330.472	-7.979	-29.546237
J3-9	J3-8	181-11-50	39-19-50	4.710	3.643	2.985	-110965.430	-4327.487	-2.087	-7.602941
J3-8	J3-7	180-48-38	40-08-28	4.700	3.593	3.030	-110961.837	-4324.457	3.928	14.113304
J3-7	J3-6	180-37-47	40-46-15	1.870	1.416	1.221	-110960.421	-4323.236	8.179	11.581464
J3-6	G3-5	180-07-10	40-53-25	10.469	7.914	6.853	-110952.507	-4316.383	16.253	128.626242
G3-5	G3-4	220-29-24	81-22-49	4.997	0.749	4.941	-110951.758	-4311.442	28.047	21.007203
G3-4	G6-32	39-58-18	301-21-07	19.314	10.049	-16.494	-110941.709	-4327.936	16.494	165.748206
									倍面積	3724.683422
									面積	1862.3417110
									坪數	563.35

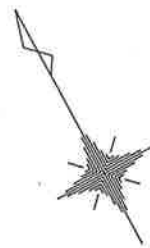
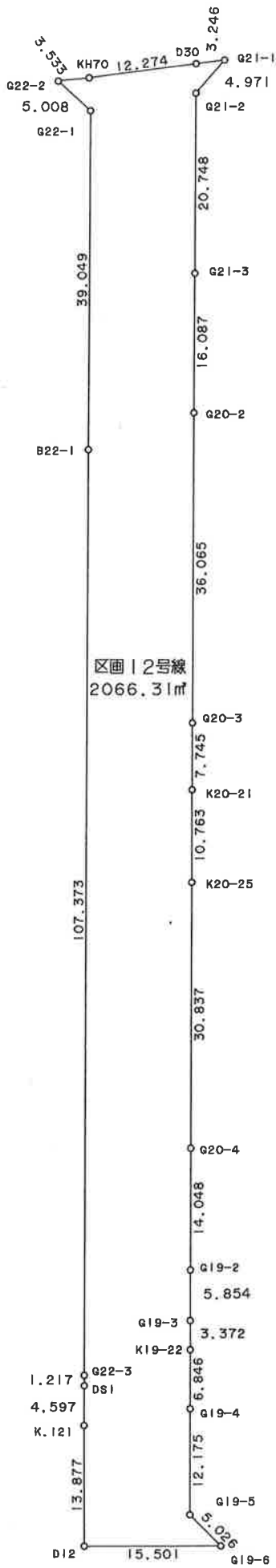

* * 面積計算 (倍横距法) * *

地 器械点	番 : 視準点	区画12号線 内角	方向角	距離	緯距	経距	X座標	Y座標	倍横距	倍面積
G22-2	G22-1	48-42-21	161-20-40	5.008	-4.745	1.602	-110621.037	-4506.111	1.602	-7.601490
G22-1	B22-1	227-45-27	209-06-07	39.049	-34.119	-18.992	-110655.156	-4525.103	-15.788	538.670772
B22-1	G22-3	180-00-02	209-06-09	107.373	-93.817	-52.223	-110748.973	-4577.326	-87.003	8162.360451
G22-3	DS1	180-07-00	209-13-09	1.217	-1.062	-0.594	-110750.035	-4577.920	-139.820	148.488840
DS1	K.121	180-00-39	209-13-48	4.597	-4.012	-2.245	-110754.047	-4580.165	-142.659	572.347908
K.121	D12	179-35-31	208-49-19	13.877	-12.158	-6.690	-110766.205	-4586.855	-151.594	1843.079852
D12	G19-6	90-00-00	118-49-19	15.501	-7.473	13.581	-110773.678	-4573.274	-144.703	1081.365519
G19-6	G19-5	45-52-12	344-41-31	5.026	4.848	-1.327	-110768.830	-4574.601	-132.449	-642.112752
G19-5	G19-4	224-26-07	29-07-38	12.175	10.635	5.926	-110758.195	-4568.675	-127.850	-1359.684750
G19-4	K19-22	179-54-31	29-02-09	6.846	5.986	3.323	-110752.209	-4565.352	-118.601	-709.945586
K19-22	G19-3	180-00-26	29-02-35	3.372	2.948	1.637	-110749.261	-4563.715	-113.641	-335.013668
G19-3	G19-2	179-57-54	29-00-29	5.854	5.120	2.839	-110744.141	-4560.876	-109.165	-558.924800
G19-2	G20-4	180-04-10	29-04-39	14.048	12.277	6.827	-110731.864	-4554.049	-99.499	-1221.549223
G20-4	K20-25	179-59-49	29-04-28	30.837	26.951	14.985	-110704.913	-4539.064	-77.687	-2093.742337
K20-25	K20-21	179-59-54	29-04-22	10.763	9.407	5.230	-110695.506	-4533.834	-57.472	-540.639104
K20-21	G20-3	180-00-15	29-04-37	7.745	6.769	3.764	-110688.737	-4530.070	-48.478	-328.147582
G20-3	G20-2	179-58-27	29-03-04	36.065	31.528	17.513	-110657.209	-4512.557	-27.201	-857.593128
G20-2	G21-3	180-03-59	29-07-03	16.087	14.054	7.828	-110643.155	-4504.729	-1.860	-26.140440
G21-3	G21-2	179-58-31	29-05-34	20.748	18.130	10.088	-110625.025	-4494.641	16.056	291.095280
G21-2	G21-1	220-19-03	69-24-37	4.971	1.748	4.653	-110623.277	-4489.988	30.797	53.833156
G21-1	D30	41-50-02	291-14-39	3.246	1.176	-3.025	-110622.101	-4493.013	32.425	38.131800
D30	KH70	180-00-31	291-15-10	12.274	4.449	-11.439	-110617.652	-4504.452	17.961	79.908489
KH70	G22-2	181-23-09	292-38-19	3.533	1.360	-3.261	-110616.292	-4507.713	3.261	4.434960
									倍面積	4132.622167
									面積	2066.3110835
									坪数	625.05

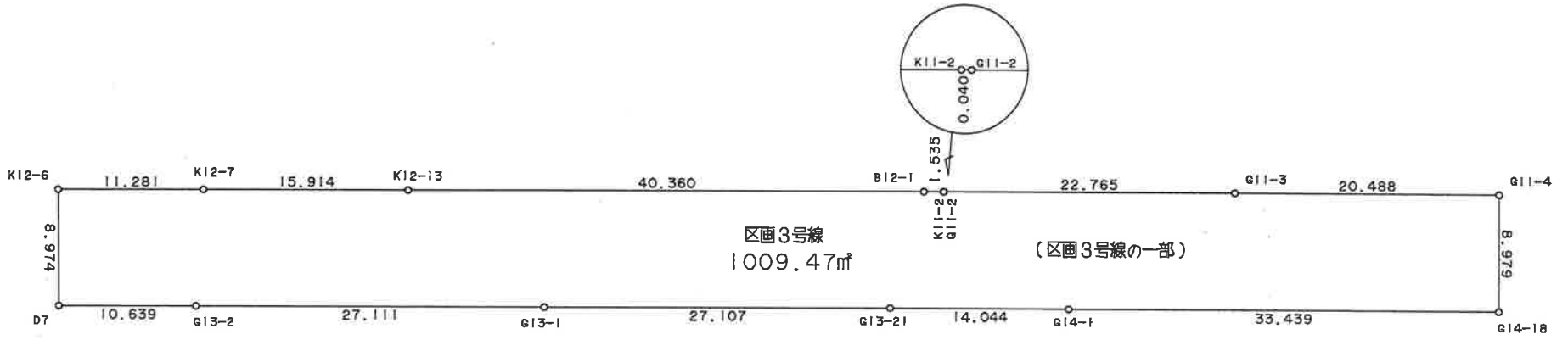

* * 面積計算 (倍橫距法) * *

地 器械点	番 : 視準点	区画 3 号線 内角	方向角	距離	緯距	經距	X座標	Y座標	倍橫距	倍面積
G11-4	G11-3	90-11-39	302-03-59	20.488	10.877	-17.362	-110744.842	-4348.542	-17.362	-188.846474
G11-3	G11-2	179-55-43	301-59-42	22.765	12.062	-19.307	-110732.780	-4367.849	-54.031	-651.721922
G11-2	K11-2	180-54-37	302-54-19	0.040	0.022	-0.034	-110732.758	-4367.883	-73.372	-1.614184
K11-2	B12-1	179-05-20	301-59-39	1.535	0.813	-1.302	-110731.945	-4369.185	-74.707	-60.743107
B12-1	K12-13	179-59-59	301-59-38	40.360	21.384	-34.229	-110710.561	-4403.414	-110.239	-2357.331364
K12-13	K12-7	180-00-02	301-59-40	15.914	8.432	-13.497	-110702.129	-4416.911	-157.965	-1331.960880
K12-7	K12-6	180-00-03	301-59-43	11.281	5.977	-9.567	-110696.152	-4426.478	-181.029	-1082.010333
K12-6	D7	89-36-17	211-36-00	8.974	-7.643	-4.702	-110703.795	-4431.180	-195.298	1492.662614
D7	G13-2	90-25-33	122-01-33	10.639	-5.642	9.020	-110709.437	-4422.160	-190.980	1077.509160
G13-2	G13-1	179-59-53	122-01-26	27.111	-14.376	22.985	-110723.813	-4399.175	-158.975	2285.424600
G13-1	G13-21	179-55-46	121-57-12	27.107	-14.346	23.000	-110738.159	-4376.175	-112.990	1620.954540
G13-21	G14-1	180-05-37	122-02-49	14.044	-7.452	11.904	-110745.611	-4364.271	-78.086	581.896872
G14-1	G14-18	179-58-45	122-01-34	33.439	-17.733	28.350	-110763.344	-4335.921	-37.832	670.874856
G14-18	G11-4	89-50-46	31-52-20	8.979	7.625	4.741	-110755.719	-4331.180	-4.741	-36.150125
									倍面積	2018.944253
									面積	1009.4721265
									坪数	305.36

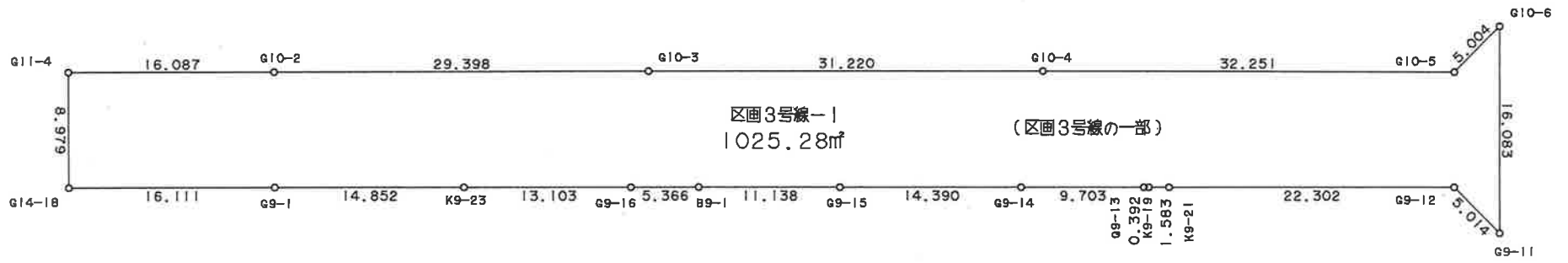

* * 面積計算 (倍横距法) * *

地 器械点	番 : 視準点	区画3号線-1 内角	方向角	距離	緯距	經距	X座標	Y座標	倍横距	倍面積
G10-6	G10-5	44-50-03	256-47-49	5.004	-1.143	-4.872	-110813.480	-4238.794	-4.872	5.568696
G10-5	G10-4	225-16-08	302-03-57	32.251	17.122	-27.331	-110796.358	-4266.125	-37.075	-634.798150
G10-4	G10-3	179-56-56	302-00-53	31.220	16.551	-26.472	-110779.807	-4292.597	-90.878	-1504.121778
G10-3	G10-2	179-56-00	301-56-53	29.398	15.556	-24.945	-110764.251	-4317.542	-142.295	-2213.541020
G10-2	G11-4	180-04-56	302-01-49	16.087	8.532	-13.638	-110755.719	-4331.180	-180.878	-1543.251096
G11-4	G14-18	89-50-31	211-52-20	8.979	-7.625	-4.741	-110763.344	-4335.921	-199.257	1519.334625
G14-18	G9-1	90-06-01	121-58-21	16.111	-8.531	13.667	-110771.875	-4322.254	-190.331	1623.713761
G9-1	K9-23	180-06-10	122-04-31	14.852	-7.887	12.585	-110779.762	-4309.669	-164.079	1294.091073
K9-23	G9-16	179-59-57	122-04-28	13.103	-6.958	11.103	-110786.720	-4298.566	-140.391	976.840578
G9-16	B9-1	179-57-06	122-01-34	5.366	-2.846	4.549	-110789.566	-4294.017	-124.739	354.952715
B9-1	G9-15	180-00-00	122-01-34	11.138	-5.906	9.443	-110795.472	-4284.574	-110.747	654.117878
G9-15	G9-14	180-00-18	122-01-52	14.390	-7.632	12.199	-110803.104	-4272.375	-89.105	680.049360
G9-14	G9-13	179-58-18	122-00-10	9.703	-5.142	8.228	-110808.246	-4264.147	-68.678	353.142276
G9-13	K9-19	179-51-48	121-51-58	0.392	-0.207	0.333	-110808.453	-4263.814	-60.117	12.444219
K9-19	K9-21	180-05-49	121-57-47	1.583	-0.838	1.343	-110809.291	-4262.471	-58.441	48.973558
K9-21	G9-12	179-59-17	121-57-04	22.302	-11.802	18.923	-110821.093	-4243.548	-38.175	450.541350
G9-12	G9-11	225-14-06	167-11-10	5.014	-4.889	1.112	-110825.982	-4242.436	-18.140	88.686460
G9-11	G10-6	44-46-36	31-57-46	16.083	13.645	8.514	-110812.337	-4233.922	-8.514	-116.173530
									倍面積	2050.570974
									面積	1025.2854872
									坪数	310.14

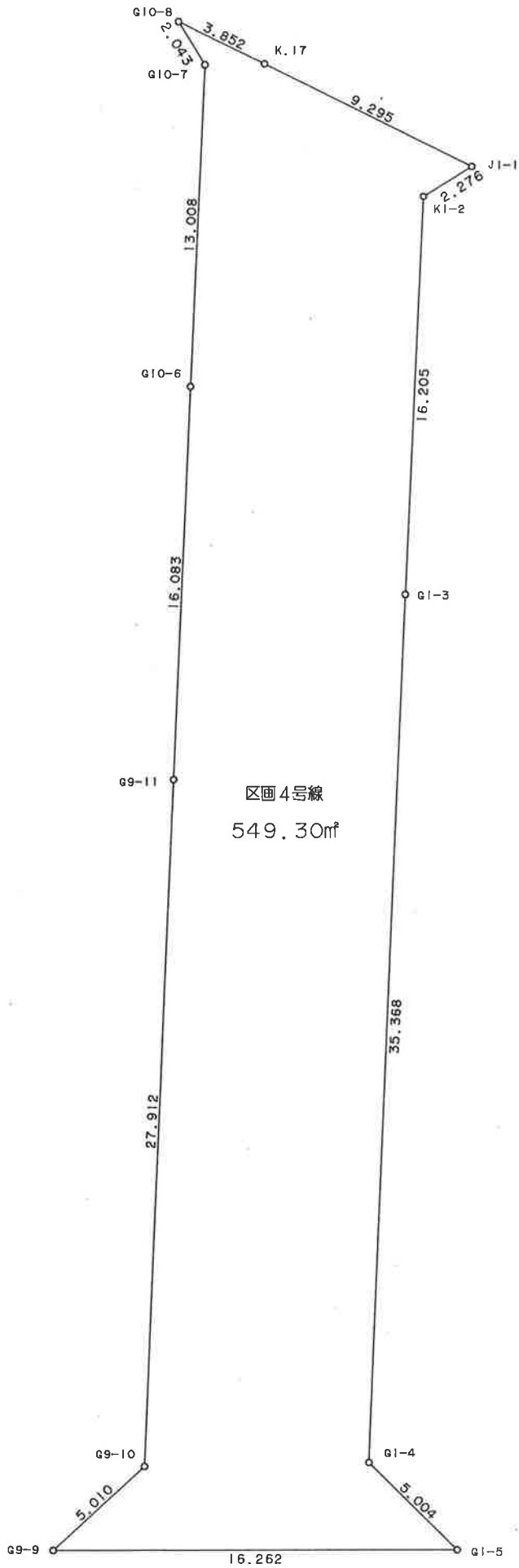

区画4号線
 549.30m²

* * 面積計算 (倍横距法) * *

地 器械点	番 : 区画4号線 視準点	内角	方向角	距離	緯距	經距	X座標	Y座標	倍横距	倍面積
G10-8	G10-7	31-53-13	177-36-55	2.043	-2.041	0.085	-110801.311	-4227.020	0.085	-0.173485
G10-7	G10-6	214-25-49	212-02-44	13.008	-11.026	-6.902	-110812.337	-4233.922	-6.732	74.227032
G10-6	G9-11	179-55-02	211-57-46	16.083	-13.645	-8.514	-110825.982	-4242.436	-22.148	302.209460
G9-11	G9-10	180-03-22	212-01-08	27.912	-23.666	-14.799	-110849.648	-4257.235	-45.461	1075.880026
G9-10	G9-9	225-06-36	257-07-44	5.010	-1.116	-4.884	-110850.764	-4262.119	-65.144	72.700704
G9-9	G1-5	42-27-41	119-35-25	16.262	-8.030	14.141	-110858.794	-4247.978	-55.887	448.772610
G1-5	G1-4	44-46-55	344-22-20	5.004	4.819	-1.348	-110853.975	-4249.326	-43.094	-207.669986
G1-4	G1-3	227-36-38	31-58-58	35.368	29.999	18.733	-110823.976	-4230.593	-25.709	-771.244291
G1-3	K1-2	180-04-10	32-03-08	16.205	13.735	8.600	-110810.241	-4221.993	1.624	22.305640
K1-2	J1-1	235-33-20	87-36-28	2.276	0.095	2.274	-110810.146	-4219.719	12.498	1.187310
J1-1	K.17	58-14-57	325-51-25	9.295	7.693	-5.217	-110802.453	-4224.936	9.555	73.506615
K.17	G10-8	179-52-17	325-43-42	3.852	3.183	-2.169	-110799.270	-4227.105	2.169	6.903927
									倍面積	1098.605562
									面積	549.3027810
									坪数	166.16

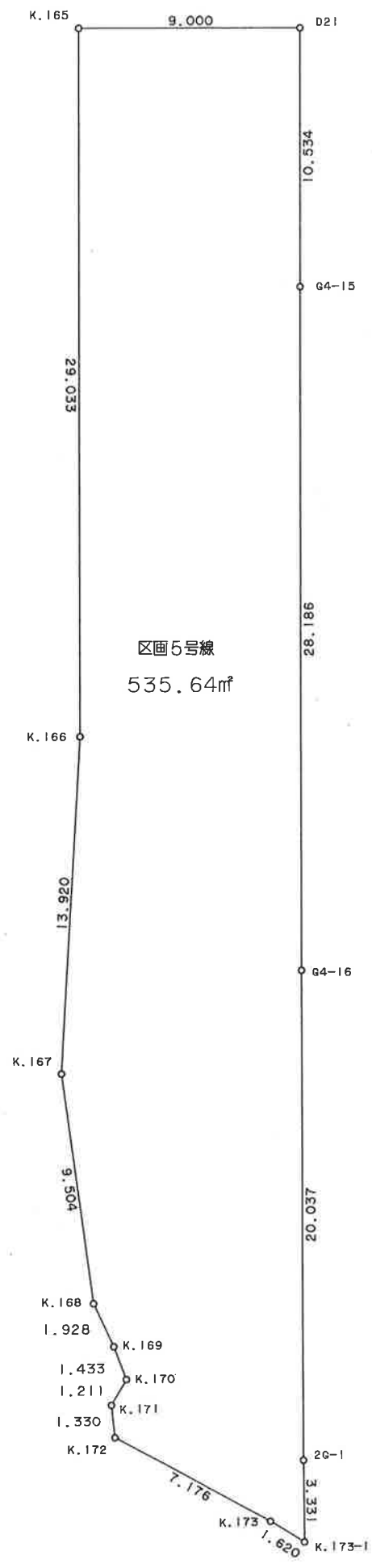
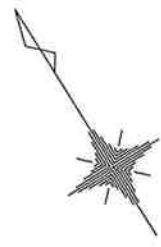

* * 面積計算 (倍横距法) * *

地 器械点	番 : 視準点	区画5号線 内角	方向角	距離	緯距	經距	X座標	Y座標	倍横距	倍面積
K.165	K.166	89-59-16	211-58-44	29.033	-24.627	-15.376	-111115.860	-4524.523	-15.376	378.664752
K.166	K.167	183-16-15	215-14-59	13.920	-11.368	-8.034	-111127.228	-4532.557	-38.786	440.919248
K.167	K.168	169-13-22	204-28-21	9.504	-8.650	-3.937	-111135.878	-4536.494	-50.757	439.048050
K.168	K.169	162-19-14	186-47-35	1.928	-1.914	-0.228	-111137.792	-4536.722	-54.922	105.120708
K.169	K.170	184-53-08	191-40-43	1.433	-1.403	-0.290	-111139.195	-4537.012	-55.440	77.782320
K.170	K.171	230-34-18	242-15-01	1.211	-0.564	-1.072	-111139.759	-4538.084	-56.802	32.036328
K.171	K.172	143-47-41	206-02-42	1.330	-1.195	-0.584	-111140.954	-4538.668	-58.458	69.857310
K.172	K.173	124-30-51	150-33-33	7.176	-6.249	3.527	-111147.203	-4535.141	-55.515	346.913235
K.173	K.173-1	182-56-21	153-29-54	1.620	-1.450	0.723	-111148.653	-4534.418	-51.265	74.334250
K.173-1	2G-1	58-08-06	31-38-00	3.331	2.836	1.747	-111145.817	-4532.671	-48.795	-138.382620
2G-1	G4-16	180-24-02	32-02-02	20.037	16.986	10.628	-111128.831	-4522.043	-36.420	-618.630120
G4-16	G4-15	179-59-05	32-01-07	28.186	23.898	14.944	-111104.933	-4507.099	-10.848	-259.245504
G4-15	D21	179-59-54	32-01-01	10.534	8.932	5.585	-111096.001	-4501.514	9.681	86.470692
D21	K.165	89-58-27	301-59-28	9.000	4.768	-7.633	-111091.233	-4509.147	7.633	36.394144
									倍面積	1071.282793
									面積	535.6413965
									坪数	162.03

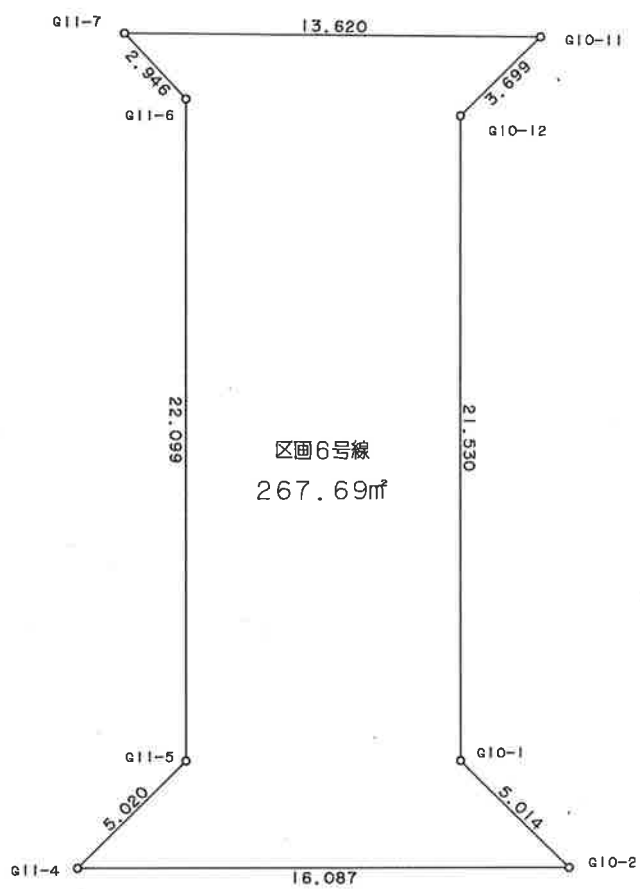
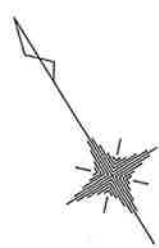

* * 面積計算 (倍橫距法) * *

地 器 械 點	番 視 準 點	區 內 角	區 號 內 角	方 向 角	距 離	緯 距	經 距	X 座 標	Y 座 標	倍 橫 距	倍 面 積
G11-7	G11-6	46-48-32	169-25-07	2.946	-2.896	0.541	-110735.855	-4314.576	0.541	-1.566736	
G11-6	G11-5	222-34-56	212-00-03	22.099	-18.741	-11.711	-110754.596	-4326.287	-10.629	199.198089	
G11-5	G11-4	225-04-23	257-04-26	5.020	-1.123	-4.893	-110755.719	-4331.180	-27.233	30.582659	
G11-4	G10-2	44-57-23	122-01-49	16.087	-8.532	13.638	-110764.251	-4317.542	-18.488	157.739616	
G10-2	G10-1	45-02-22	347-04-11	5.014	4.887	-1.122	-110759.364	-4318.664	-5.972	-29.185164	
G10-1	G10-12	224-55-58	32-00-09	21.530	18.258	11.410	-110741.106	-4307.254	4.316	78.801528	
G10-12	G10-11	225-23-47	77-23-56	3.699	0.807	3.610	-110740.299	-4303.644	19.336	15.604152	
G10-11	G11-7	45-12-39	302-36-35	13.620	7.340	-11.473	-110732.959	-4315.117	11.473	84.211820	
										倍面積	535.385964
										面積	267.6929820
										坪數	80.97

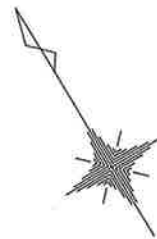
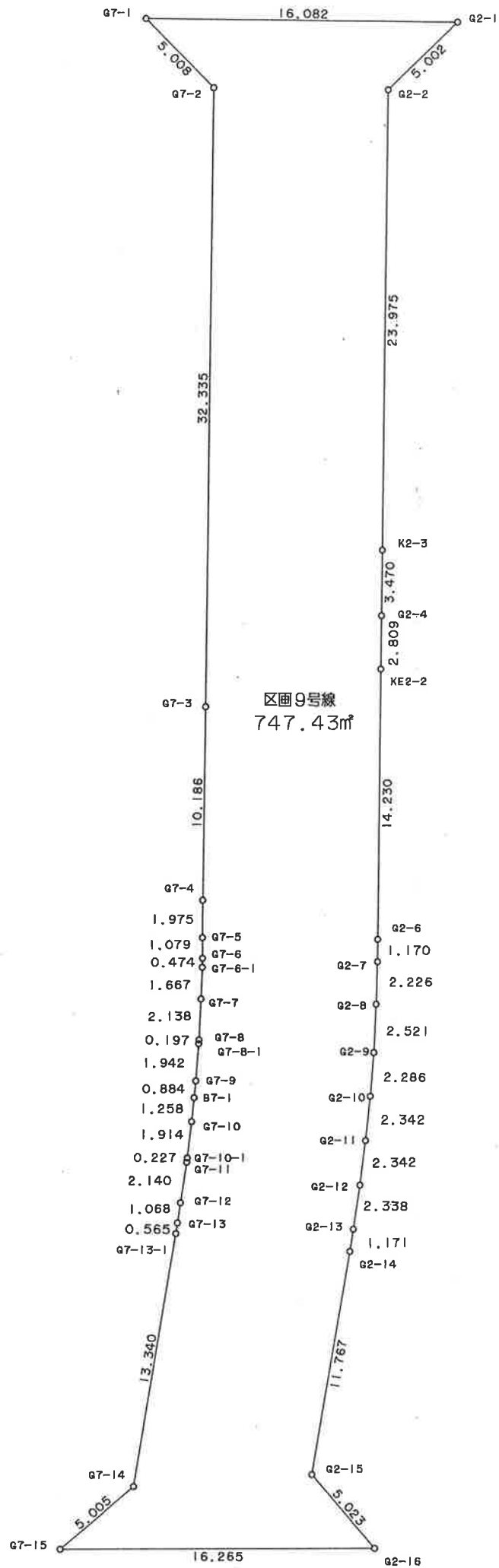

* * 面積計算 (倍横距法) * *

地 器械点	番 視準点	区画9号線 内角	方向角	距離	緯距	經距	X座標	Y座標	倍横距	倍面積
G7-1	G7-2	44-53-45	166-58-16	5.008	-4.879	1.129	-110872.591	-4271.591	1.129	-5.508391
G7-2	G7-3	225-02-15	212-00-31	32.335	-27.419	-17.139	-110900.010	-4288.730	-14.881	408.022139
G7-3	G7-4	180-11-35	212-12-06	10.186	-8.619	-5.428	-110908.629	-4294.158	-37.448	322.764312
G7-4	G7-5	179-38-16	211-50-22	1.975	-1.678	-1.042	-110910.307	-4295.200	-43.918	73.694404
G7-5	G7-6	179-21-40	211-12-02	1.079	-0.923	-0.559	-110911.230	-4295.759	-45.519	42.014037
G7-6	G7-6-1	181-12-54	212-24-56	0.474	-0.400	-0.254	-110911.630	-4296.013	-46.332	18.532800
G7-6-1	G7-7	181-15-20	213-40-16	1.667	-1.387	-0.924	-110913.017	-4296.937	-47.510	65.896370
G7-7	G7-8	180-38-09	214-18-25	2.138	-1.766	-1.205	-110914.783	-4298.142	-49.639	87.662474
G7-8	G7-8-1	181-23-59	215-42-24	0.197	-0.160	-0.115	-110914.943	-4298.257	-50.959	8.153440
G7-8-1	G7-9	180-05-42	215-48-06	1.942	-1.575	-1.136	-110916.518	-4299.393	-52.210	82.230750
G7-9	B7-1	181-25-52	217-13-58	0.884	-0.704	-0.535	-110917.222	-4299.928	-53.881	37.932224
B7-1	G7-10	179-59-00	217-12-58	1.258	-1.002	-0.761	-110918.224	-4300.689	-55.177	55.287354
G7-10	G7-10-1	180-48-12	218-01-10	1.914	-1.508	-1.179	-110919.732	-4301.868	-57.117	86.132436
G7-10-1	G7-11	181-37-29	219-38-39	0.227	-0.175	-0.145	-110919.907	-4302.013	-58.441	10.227175
G7-11	G7-12	180-16-28	219-55-07	2.140	-1.641	-1.373	-110921.548	-4303.386	-59.959	98.392719
G7-12	G7-13	179-57-20	219-52-27	1.068	-0.820	-0.685	-110922.368	-4304.071	-62.017	50.853940
G7-13	G7-13-1	180-14-35	220-07-02	0.565	-0.432	-0.364	-110922.800	-4304.435	-63.066	27.244512
G7-13-1	G7-14	180-47-51	220-54-53	13.340	-10.081	-8.737	-110932.881	-4313.172	-72.167	727.515527
G7-14	G7-15	220-18-56	261-13-49	5.005	-0.763	-4.946	-110933.644	-4318.118	-85.850	65.503550
G7-15	G2-16	40-08-09	121-21-58	16.265	-8.466	13.888	-110942.110	-4304.230	-76.908	651.103128
G2-16	G2-15	49-47-32	351-09-30	5.023	4.963	-0.772	-110937.147	-4305.002	-63.792	-316.599696
G2-15	G2-14	229-56-16	41-05-46	11.767	8.868	7.735	-110928.279	-4297.267	-56.829	-503.959572
G2-14	G2-13	179-09-37	40-15-23	1.171	0.894	0.757	-110927.385	-4296.510	-48.337	-43.213278
G2-13	G2-12	179-30-08	39-45-31	2.338	1.797	1.495	-110925.588	-4295.015	-46.085	-82.814745
G2-12	G2-11	178-46-30	38-32-01	2.342	1.832	1.459	-110923.756	-4293.556	-43.131	-79.015992
G2-11	G2-10	178-58-20	37-30-21	2.342	1.858	1.426	-110921.898	-4292.130	-40.246	-74.777068
G2-10	G2-9	178-31-37	36-01-58	2.286	1.849	1.345	-110920.049	-4290.785	-37.475	-69.291275

器械点	視準点	内角	方向角	距離	緯距	經距	X座標	Y座標	倍橫距	倍面積
G2-9	G2-8	178-03-16	34-05-14	2.521	2.088	1.413	-110917.961	-4289.372	-34.717	-72.489096
G2-8	G2-7	179-10-54	33-16-08	2.226	1.861	1.221	-110916.100	-4288.151	-32.083	-59.706463
G2-7	G2-6	178-44-11	32-00-19	1.170	0.992	0.620	-110915.108	-4287.531	-30.242	-30.000064
G2-6	KE2-2	179-58-57	31-59-16	14.230	12.069	7.538	-110903.039	-4279.993	-22.084	-266.531796
KE2-2	G2-4	180-00-17	31-59-33	2.809	2.382	1.488	-110900.657	-4278.505	-13.058	-31.104156
G2-4	K2-3	179-59-37	31-59-10	3.470	2.943	1.838	-110897.714	-4276.667	-9.732	-28.641276
K2-3	G2-2	180-00-13	31-59-23	23.975	20.334	12.701	-110877.380	-4263.966	4.807	97.745538
G2-2	G2-1	224-58-37	76-58-00	5.002	1.128	4.873	-110876.252	-4259.093	22.381	25.245768
G2-1	G7-1	45-06-31	302-04-31	16.082	8.540	-13.627	-110867.712	-4272.720	13.627	116.374580
									倍面積	1494.876309
									面積	747.4381545
									坪数	226.10

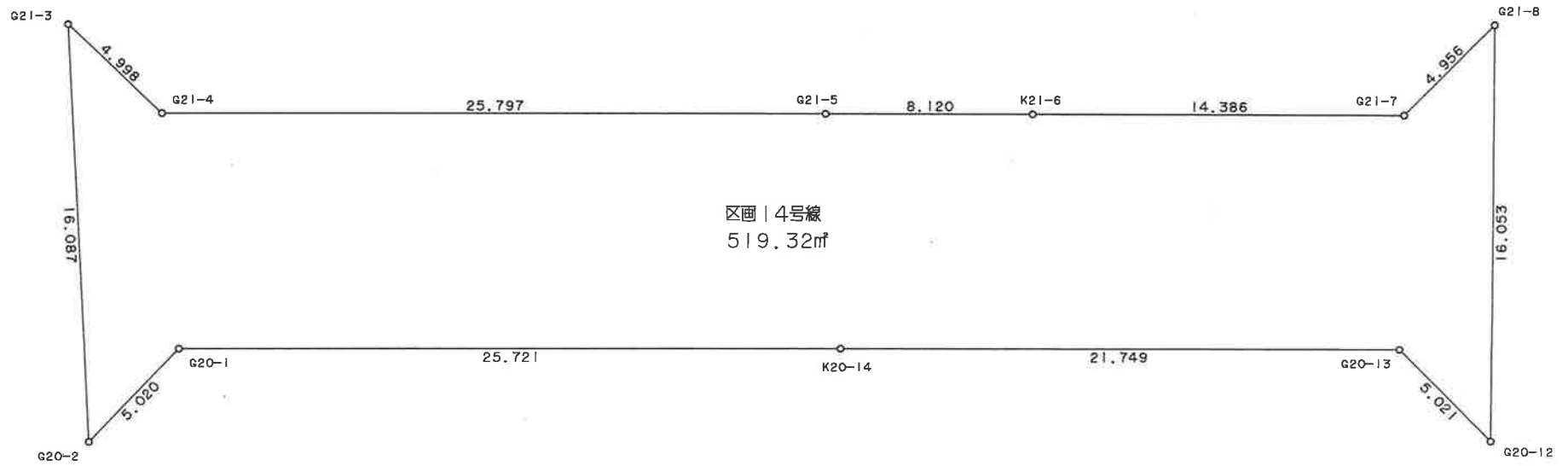
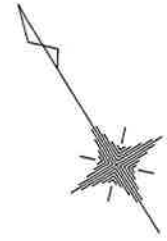

* * 面積計算 (倍横距法) * *

地 器械点	番 : 視準点	区画14号線 内角	方向角	距離	緯距	經距	X座標	Y座標	倍横距	倍面積
G20-2	G20-1	46-49-47	75-56-50	5.020	1.219	4.870	-110655.990	-4507.687	4.870	5.936530
G20-1	K20-14	226-02-04	121-58-54	25.721	-13.623	21.817	-110669.613	-4485.870	31.557	-429.901011
K20-14	G20-13	180-00-05	121-58-59	21.749	-11.520	18.448	-110681.133	-4467.422	71.822	-827.389440
G20-13	G20-12	225-09-45	167-08-44	5.021	-4.895	1.117	-110686.028	-4466.305	91.387	-447.339365
G20-12	G21-8	45-15-20	32-24-04	16.053	13.554	8.602	-110672.474	-4457.703	101.106	1370.390724
G21-8	G21-7	44-23-03	256-47-07	4.956	-1.133	-4.825	-110673.607	-4462.528	104.883	-118.832439
G21-7	K21-6	225-15-03	302-02-10	14.386	7.631	-12.195	-110665.976	-4474.723	87.863	670.482553
K21-6	G21-5	179-58-50	302-01-00	8.120	4.305	-6.885	-110661.671	-4481.608	68.783	296.110815
G21-5	G21-4	179-59-56	302-00-56	25.797	13.676	-21.873	-110647.995	-4503.481	40.025	547.381900
G21-4	G21-3	223-31-32	345-32-28	4.998	4.840	-1.248	-110643.155	-4504.729	16.904	81.815360
G21-3	G20-2	43-34-35	209-07-03	16.087	-14.054	-7.828	-110657.209	-4512.557	7.828	-110.014712
									倍面積	1038.640915
									面積	519.3204575
									坪数	157.09

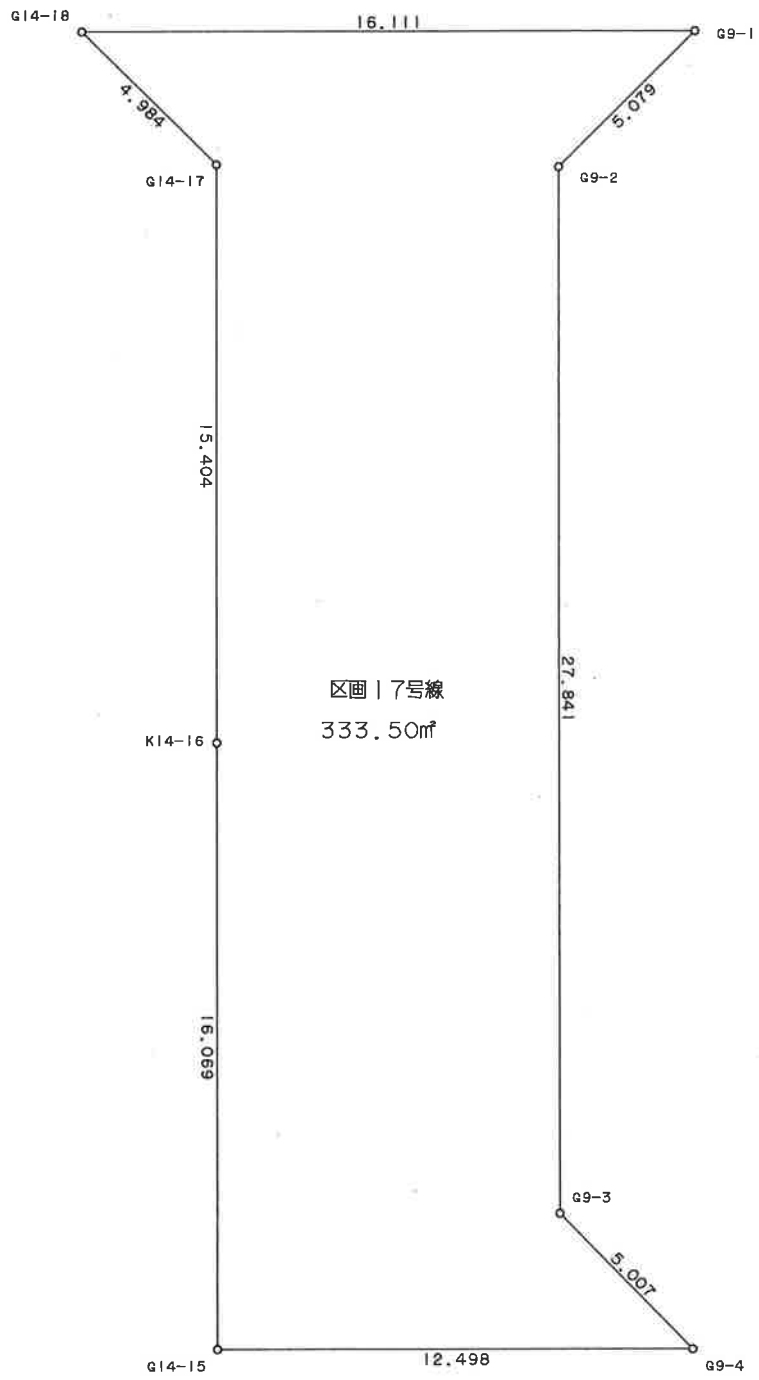
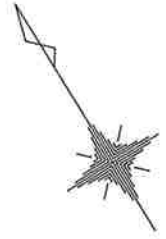

* * 面積計算 (倍横距法) * *

地 器械点	番 : 視準点	区画17号線 内角	方向角	距離	緯距	經距	X座標	Y座標	倍横距	倍面積
G14-18	G14-17	44-54-01	166-52-22	4.984	-4.854	1.132	-110768.198	-4334.789	1.132	-5.494728
G14-17	K14-16	225-07-42	212-00-04	15.404	-13.063	-8.163	-110781.261	-4342.952	-5.899	77.058637
K14-16	G14-15	180-01-49	212-01-53	16.069	-13.623	-8.523	-110794.884	-4351.475	-22.585	307.675455
G14-15	G9-4	90-01-20	122-03-13	12.498	-6.633	10.593	-110801.517	-4340.882	-20.515	136.075995
G9-4	G9-3	45-38-32	347-41-45	5.007	4.892	-1.067	-110796.625	-4341.949	-10.989	-53.758188
G9-3	G9-2	224-16-54	31-58-39	27.841	23.616	14.744	-110773.009	-4327.205	2.688	63.479808
G9-2	G9-1	225-07-18	77-05-57	5.079	1.134	4.951	-110771.875	-4322.254	22.383	25.382322
G9-1	G14-18	44-52-24	301-58-21	16.111	8.531	-13.667	-110763.344	-4335.921	13.667	116.593177
									倍面積	667.012478
									面積	333.5062390
									坪数	100.88

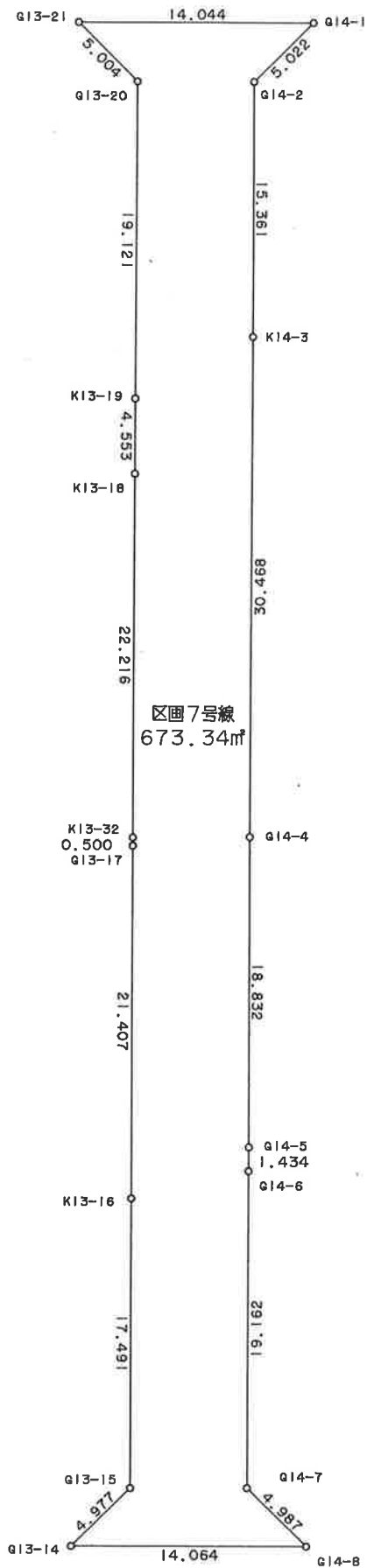
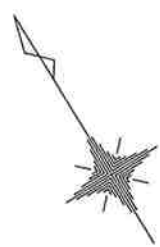

* * 面積計算 (倍横距法) * *

地 器械点	番 : 視準点	区画7号線 内角	方向角	距離	緯距	経距	X座標	Y座標	倍横距	倍面積
G13-21	G13-20	45-17-20	167-20-09	5.004	-4.882	1.097	-110743.041	-4375.078	1.097	-5.355554
G13-20	K13-19	224-40-37	212-00-46	19.121	-16.213	-10.136	-110759.254	-4385.214	-7.942	128.763646
K13-19	K13-18	179-59-29	212-00-15	4.553	-3.861	-2.413	-110763.115	-4387.627	-20.491	79.115751
K13-18	K13-32	180-00-30	212-00-45	22.216	-18.838	-11.777	-110781.953	-4399.404	-34.681	653.320678
K13-32	G13-17	179-59-34	212-00-19	0.500	-0.424	-0.265	-110782.377	-4399.669	-46.723	19.810552
G13-17	K13-16	180-00-03	212-00-22	21.407	-18.153	-11.346	-110800.530	-4411.015	-58.334	1058.937102
K13-16	G13-15	180-00-07	212-00-29	17.491	-14.832	-9.271	-110815.362	-4420.286	-78.951	1171.001232
G13-15	G13-14	225-16-15	257-16-44	4.977	-1.096	-4.855	-110816.458	-4425.141	-93.077	102.012392
G13-14	G14-8	44-45-57	122-02-41	14.064	-7.462	11.921	-110823.920	-4413.220	-86.011	641.814082
G14-8	G14-7	45-00-01	347-02-42	4.987	4.860	-1.118	-110819.060	-4414.338	-75.208	-365.510880
G14-7	G14-6	225-03-33	32-06-15	19.162	16.232	10.184	-110802.828	-4404.154	-66.142	-1073.616944
G14-6	G14-5	179-57-23	32-03-38	1.434	1.215	0.761	-110801.613	-4403.393	-55.197	-67.064355
G14-5	G14-4	179-53-12	31-56-50	18.832	15.980	9.965	-110785.633	-4393.428	-44.471	-710.646580
G14-4	K14-3	180-05-55	32-02-45	30.468	25.825	16.166	-110759.808	-4377.262	-18.340	-473.630500
K14-3	G14-2	179-46-58	31-49-43	15.361	13.051	8.101	-110746.757	-4369.161	5.927	77.353277
G14-2	G14-1	224-58-55	76-48-38	5.022	1.146	4.890	-110745.611	-4364.271	18.918	21.680028
G14-1	G13-21	45-14-11	302-02-49	14.044	7.452	-11.904	-110738.159	-4376.175	11.904	88.708608
									倍面積	1346.692535
									面積	673.3462675
									坪数	203.68

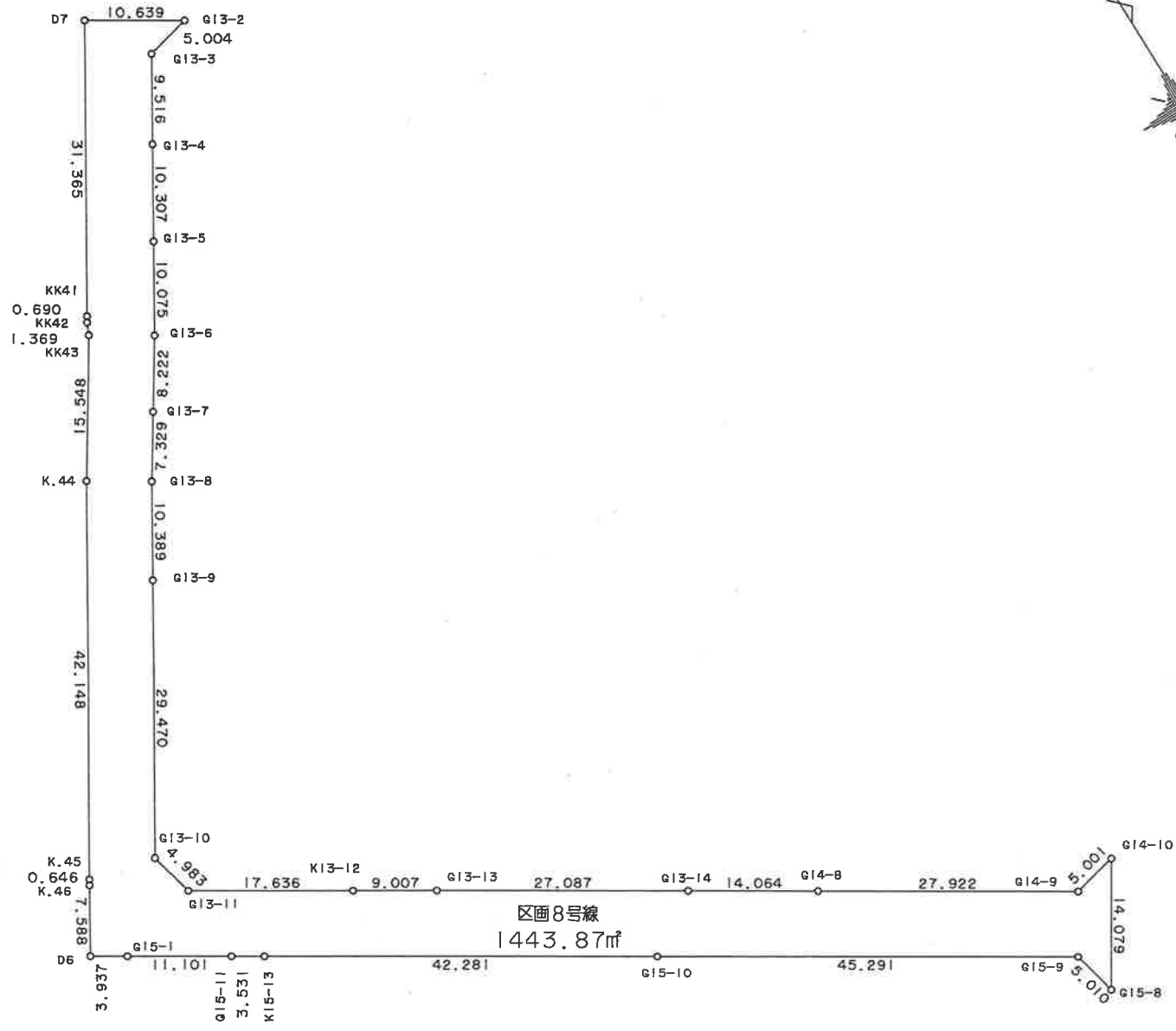
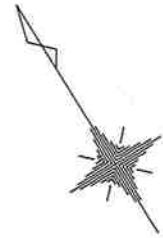

* * 面積計算 (倍横距法) * *

地 器械点	番 : 区画 8 号線 視準点	内角	方向角	距離	緯距	經距	X座標	Y座標	倍横距	倍面積
D7	KK41	89-34-29	211-36-02	31.365	-26.714	-16.435	-110730.509	-4447.615	-16.435	439.044590
KK41	KK42	180-07-55	211-43-57	0.690	-0.587	-0.363	-110731.096	-4447.978	-33.233	19.507771
KK42	KK43	172-16-06	204-00-03	1.369	-1.251	-0.557	-110732.347	-4448.535	-34.153	42.725403
KK43	K.44	188-54-08	212-54-11	15.548	-13.054	-8.446	-110745.401	-4456.981	-43.156	563.358424
K.44	K.45	178-34-55	211-29-06	42.148	-35.943	-22.013	-110781.344	-4478.994	-73.615	2645.943945
K.45	K.46	178-55-52	210-24-58	0.646	-0.557	-0.327	-110781.901	-4479.321	-95.955	53.446935
K.46	D6	180-44-35	211-09-33	7.588	-6.493	-3.926	-110788.394	-4483.247	-100.208	650.650544
D6	G15-1	90-52-04	122-01-37	3.937	-2.088	3.338	-110790.482	-4479.909	-100.796	210.462048
G15-1	G15-11	180-00-19	122-01-56	11.101	-5.888	9.411	-110796.370	-4470.498	-88.047	518.420736
G15-11	K15-13	179-59-01	122-00-57	3.531	-1.872	2.994	-110798.242	-4467.504	-75.642	141.601824
K15-13	G15-10	180-00-31	122-01-28	42.281	-22.421	35.847	-110820.663	-4431.657	-36.801	825.115221
G15-10	G15-9	179-58-44	122-00-12	45.291	-24.003	38.408	-110844.666	-4393.249	37.454	-899.008362
G15-9	G15-8	224-59-52	167-00-04	5.010	-4.882	1.127	-110849.548	-4392.122	76.989	-375.860298
G15-8	G14-10	44-54-35	31-54-39	14.079	11.951	7.442	-110837.597	-4384.680	85.558	1022.503658
G14-10	G14-9	44-58-12	256-52-51	5.001	-1.135	-4.870	-110838.732	-4389.550	88.130	-100.027550
G14-9	G14-8	225-09-23	302-02-14	27.922	14.812	-23.670	-110823.920	-4413.220	59.590	882.647080
G14-8	G13-14	180-00-27	302-02-41	14.064	7.462	-11.921	-110816.458	-4425.141	23.999	179.080538
G13-14	G13-13	180-00-21	302-03-02	27.087	14.374	-22.958	-110802.084	-4448.099	-10.880	-156.389120
G13-13	K13-12	179-56-31	301-59-33	9.007	4.772	-7.639	-110797.312	-4455.738	-41.477	-197.928244
K13-12	G13-11	180-00-15	301-59-48	17.636	9.345	-14.957	-110787.967	-4470.695	-64.073	-598.762185
G13-11	G13-10	224-20-27	346-20-15	4.983	4.842	-1.177	-110783.125	-4471.872	-80.207	-388.362294
G13-10	G13-9	225-04-51	31-25-06	29.470	25.149	15.362	-110757.976	-4456.510	-66.022	-1660.387278
G13-9	G13-8	179-56-40	31-21-46	10.389	8.871	5.407	-110749.105	-4451.103	-45.253	-401.439363
G13-8	G13-7	181-43-59	33-05-45	7.329	6.140	4.002	-110742.965	-4447.101	-35.844	-220.082160
G13-7	G13-6	179-59-49	33-05-34	8.222	6.888	4.489	-110736.077	-4442.612	-27.353	-188.407464
G13-6	G13-5	178-20-28	31-26-02	10.075	8.596	5.254	-110727.481	-4437.358	-17.610	-151.375560
G13-5	G13-4	179-58-03	31-24-05	10.307	8.797	5.370	-110718.684	-4431.988	-6.986	-61.455842

器械点	視準点	内角	方向角	距離	緯距	經距	X座標	Y座標	倍橫距	倍面積
G13-4	G13-3	179-56-55	31-21-00	9.516	8.127	4.951	-110710.557	-4427.037	3.335	27.103545
G13-3	G13-2	225-42-59	77-03-59	5.004	1.120	4.877	-110709.437	-4422.160	13.163	14.742560
G13-2	D7	44-57-34	302-01-33	10.639	5.642	-9.020	-110703.795	-4431.180	9.020	50.890840
									倍面積	2887.759942
									面積	1443.8799710
									坪数	436.77